

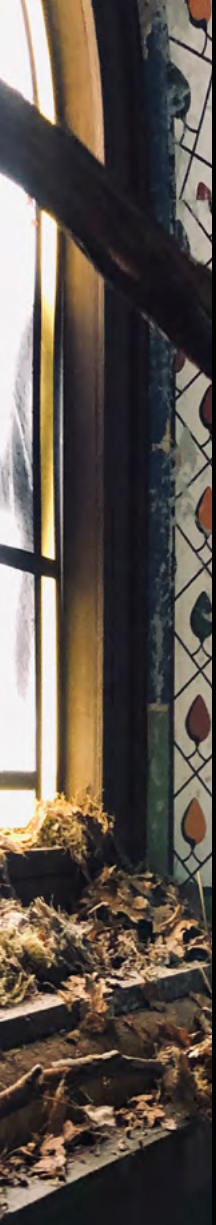

Britt Doughty, production designer

Design Presentation for EPS 204, 208, 210



204
210

Romanian Church

Was this a church once? She's not sure. But one thing is for certain -- something terrible happened here.



Set Photos



204
210

Romanian Church

This studio set was based on a Toronto location. The location was shot as the 1989 pre-destroyed look. The exterior of the church was shot in Constanta, Romania.



Set Photos



204
210

Romanian Church

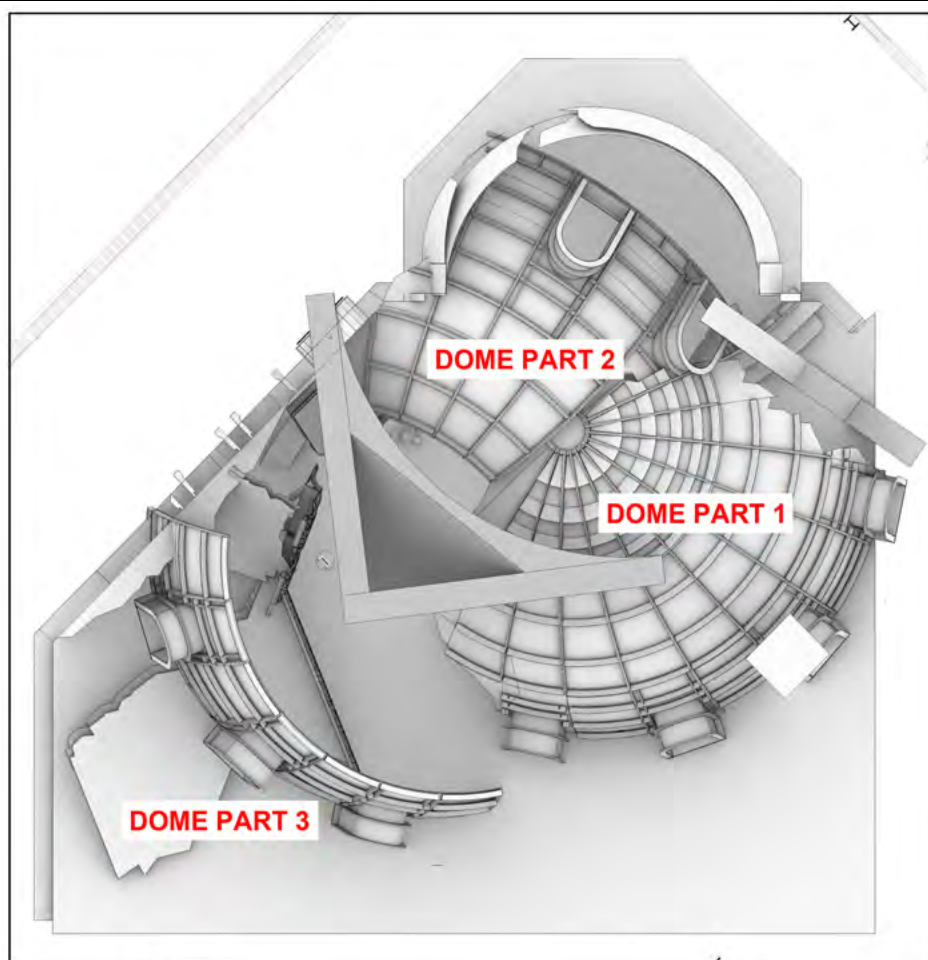

1 DOME PLACEMENT - PLAN VIEW
2/208 NOT TO SCALE

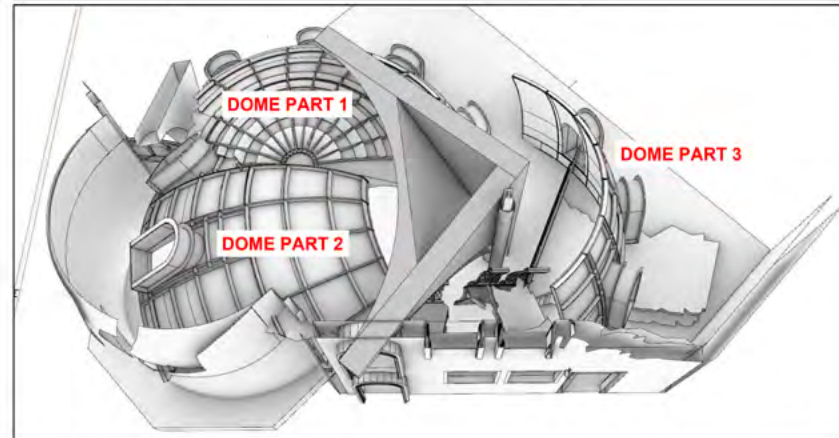
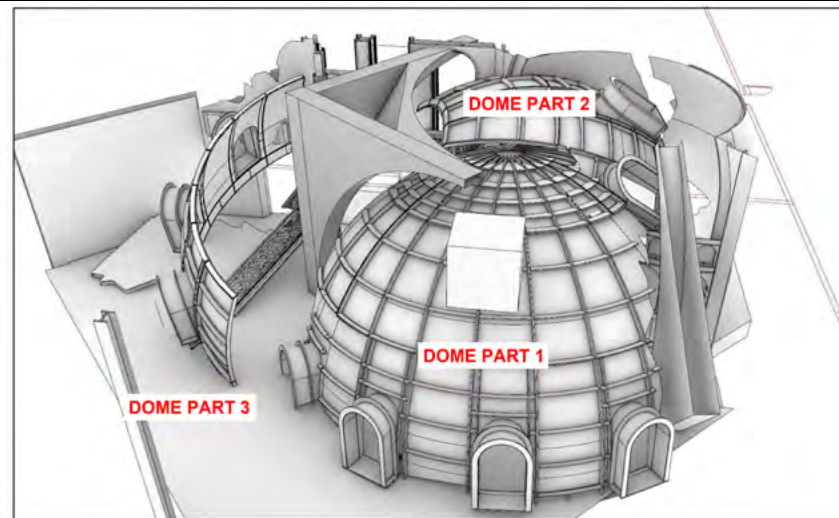

2 DOME PLACEMENT - PERSPECTIVE VIEWS
2/208 NOT TO SCALE



204

Romanian Church

The exterior of the church was shot in Constanta, Romania.

Meanwhile, back in Reston, NY ...



**208 The Water
Tower**

Henry unzips her backpack to reveal cans of spray paint. She dons her painter's mask, grabs a can and faces the water tower --- A BLANK CANVAS.



Location



Set Photo - Pre mural



208

The Water Tower

This was a studio set replica section of the water tower silo which had several peel away layers to reveal the progress of Henry's mural. Original art by Britt Doughty.

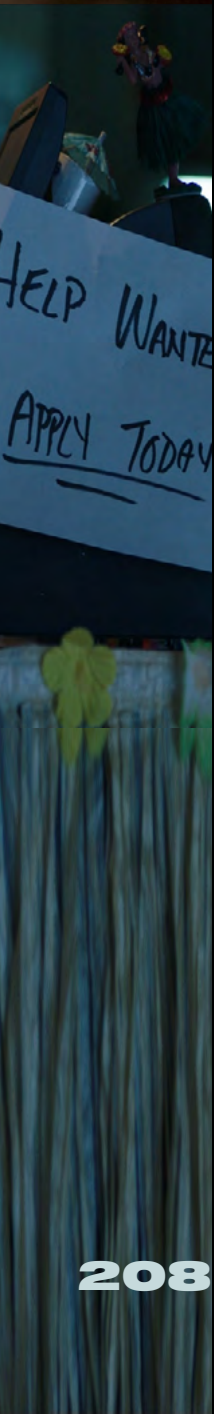

208

Surf N' Pizza

Henry gets a job ...



Before



After





Before



After





Before



After



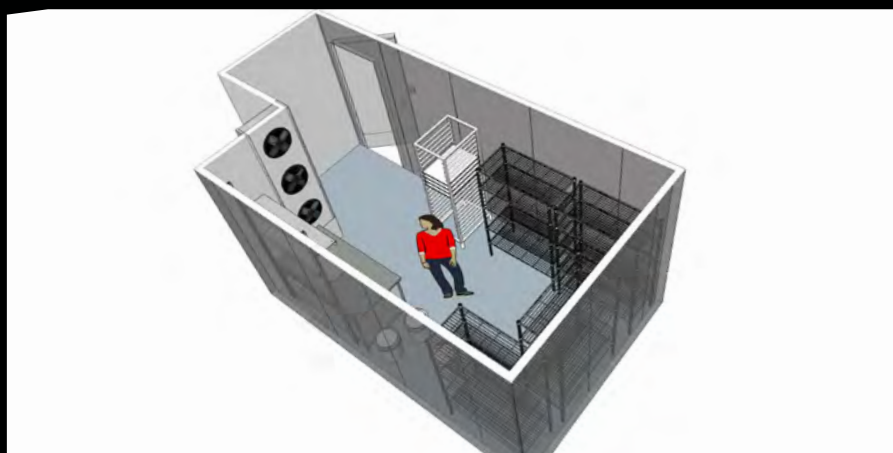

208

Surf N' Pizza

This was a studio set that tied to the location set.



208
210

Tristay Motel

There is almost no sign that anyone is staying here --
except for a goldfish. Weird.



208
210

Tristay Motel

This was a studio set. A location was used for the exterior action.



Set Photos



208
210

**Tristay
Motel**



Britt



Rachel
Woroner

210 **Cleo &
Henry's Apt**

"This is going to be a fresh start for us. A clean slate."
Cleo Coles



Britt Doughty

Set Photos



210 Cleo & Henry's Apt

This was a studio set. A location was used for the exterior action.

FRAGILE
PLEASE HANDLE
WITH CARE



Rachel
Woroner

Set Photos

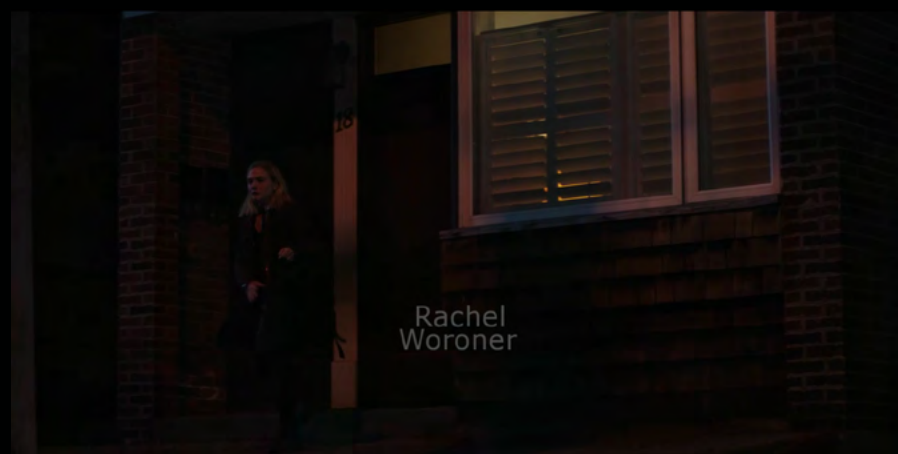

Rachel
Woroner

210

**Cleo &
Henry's Apt**

A location was used for the exterior action.



210

Remote Cave

She peers over the edge, searching for any signs of life.
But there's nothing. What the fuck has Henry done?



Set Photos



210 Remote Cave

This was a studio set built outside to benefit the SFX elements, lighting and scale.

**Flashback to 1989 Romania & Canada
Nikolai's story**



**204 Nikolai's
Apartment**

OPEN ON a rustic living room -- floral-patterned wallpaper, thick red rugs, a scuffed dining room table with lace placemats. Continue across the room to find -- a plastic tube television crammed next to a tufted couch, and above it a Bob Ross-style painting hanging in a cheaply-gilded frame...

The room is a throwback. Why wouldn't it be? We're in Romania in the mid-1980's.



Set Photos



204

Nikolai's Apartment

This was a studio set. The exterior of the apartment was shot in Bucharest, Romania.



204 **Nikolai's
Apartment**

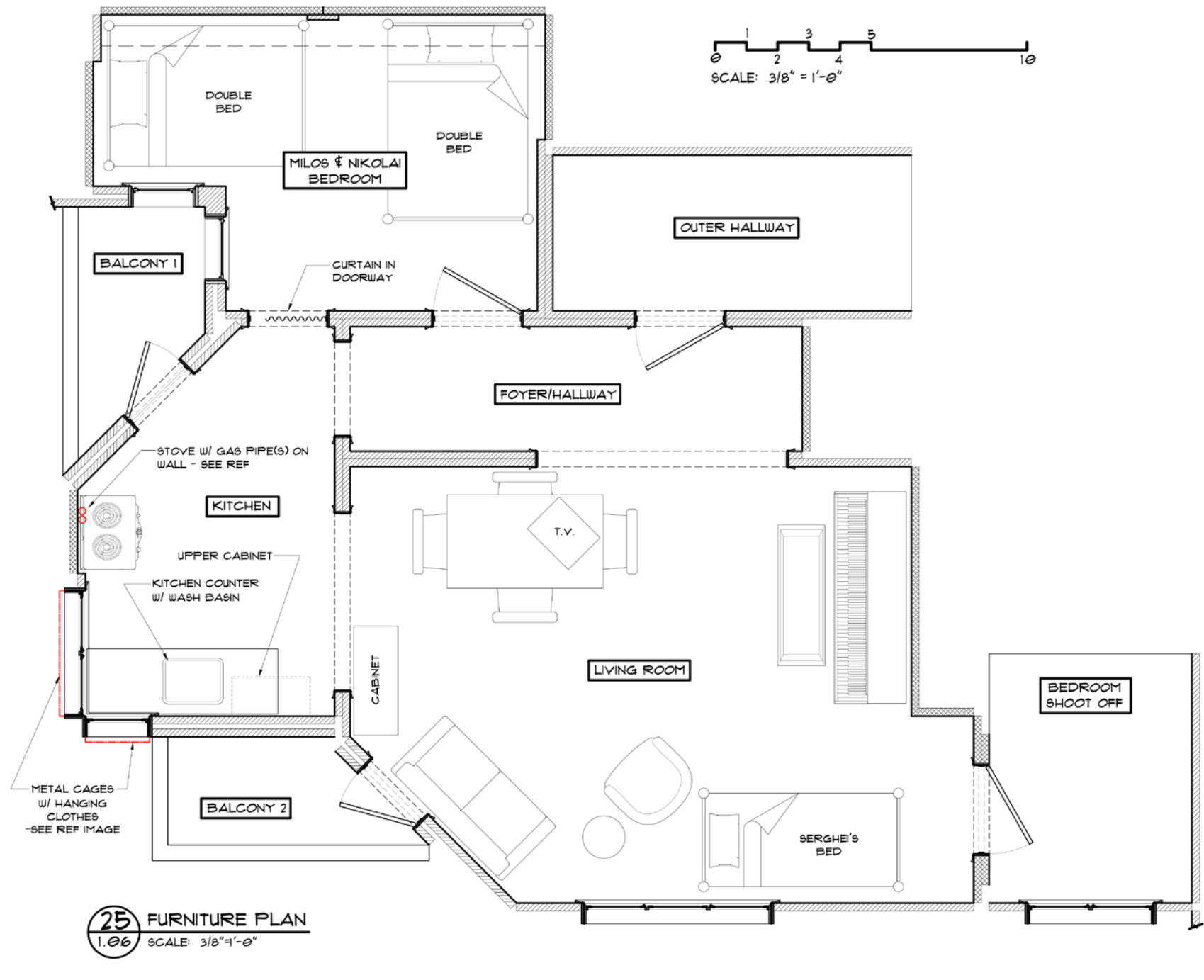

204 Nikolai's Apartment



**204 Nikolai's
Apartment**

The exterior of the apartment was shot in Bucharest, Romania.



Britt Doughty

**204 Local Cafe
Bucharest**

Romanian FOLK MUSIC pipes in over cheap speakers.
Cigarette smoke clouds a dimly lit room where fat-faced
MEN with mustaches drink at old wooden tables.



Before



After



204

Local Cafe Bucharest

This location in Bucharest played in a variety of time periods.



Before



After (present day dressed set looking at a photo from the past!)





**204 Modest
Apartment**

Nikolai shuts the door behind him and looks around the living room of a modest, sparsely furnished apartment. The floor is bare, the living room messy, and a framed propagandist painting of Nicolae Ceausescu hangs askew on the wall.



Before



After



204

Modest Apartment

This was a location in Bucharest, Romania.



Before



After



204

Modest Apartment

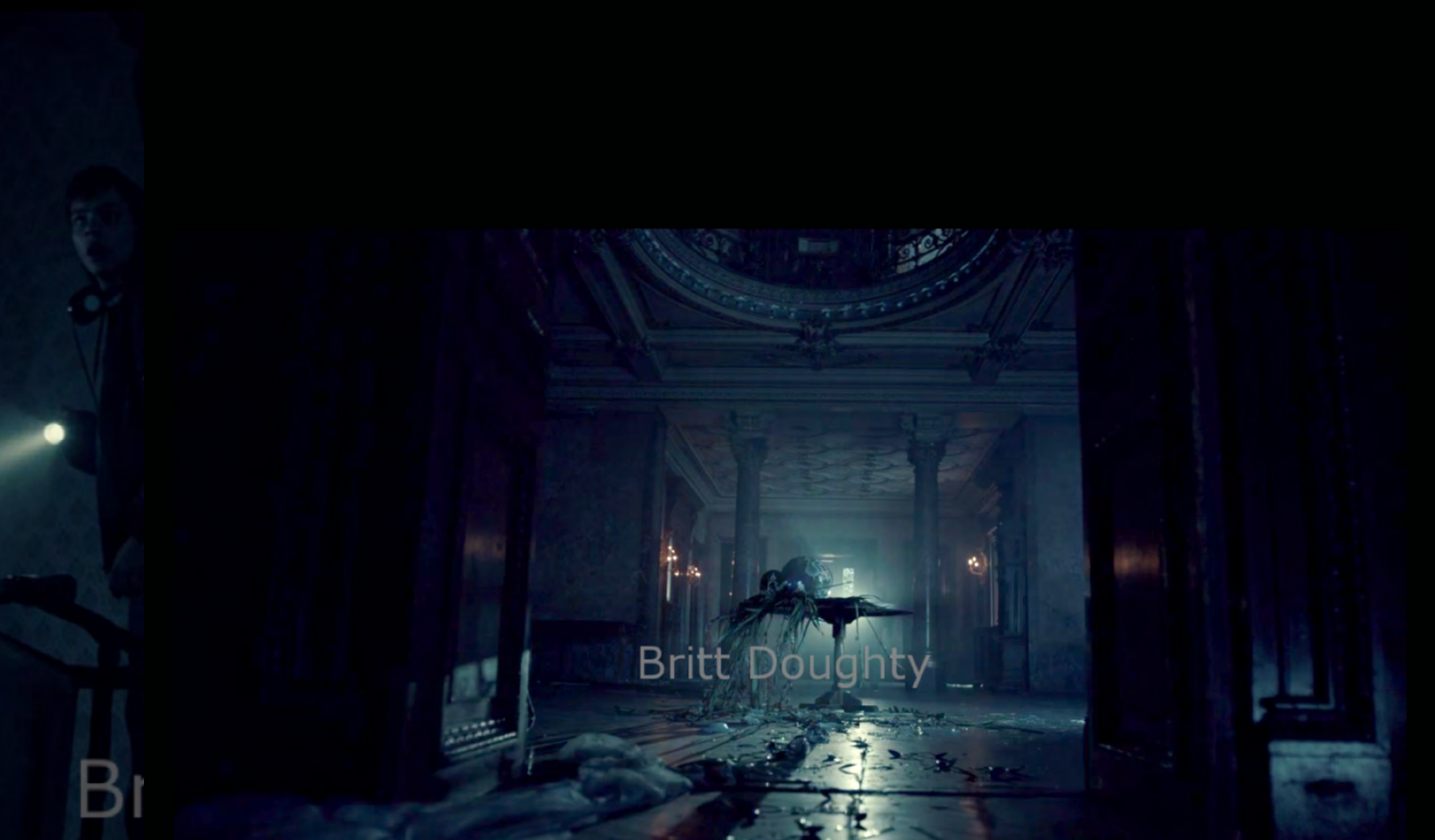

Britt Doughty

204

Romanian Mansion

After a beat, Nikolai shines the dim light across the space to see -- toppled furniture and broken glass. The house has already been looted. As he steps further, GLASS CRUNCHES under his feet.



Britt Doughty

Before



After



Britt Doughty

204 Romanian Mansion

This was a location in Bucharest, Romania.



Before



After



204 Romanian Mansion



204

Kido Estate

This was a location in Toronto which played in two time periods - 1989 and present day.



Before



After



204 **Kido Estate**
1989



Before



After



204

**Kido Estate
Present Day**

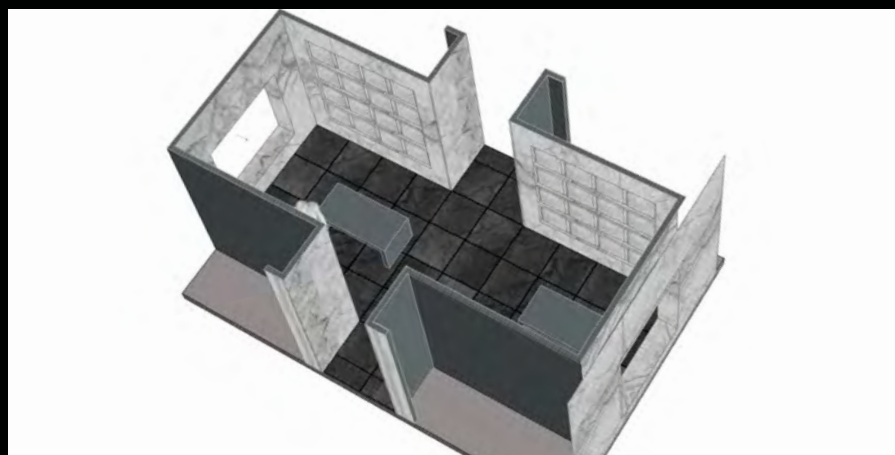

210

Kido Estate Mausoleum

This was a set built outside at a park location in Toronto.

While Henry's world grows, so do others



210

Remote Cabin

We linked two different locations - a quarry for exterior and a cabin for interior - to create the remote cabin in a barren wasteland. VFX support was used to link the two.



Before



After



210

Nikolai's Garage

This was a location in Toronto.



Before



After



210 Mega Church

This was a location in Toronto.



Before



After



208

Anna's Apartment

This was a location in Toronto.



208
210

Guidance Office

This was an additional office added to the existing school set from season one.



Before



After



210 Visitation Room

This was a location in Toronto.

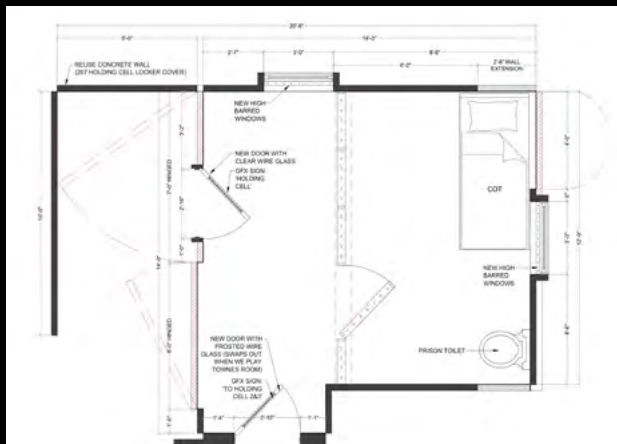

208 Holding Cell

This was a set built in studio.



Before

After (Set Photo)



210

Clay's Bedroom

This was a location in Toronto.

**Henry is far from home, and exactly
where she needs to be.**



Britt Doughty

210 Barcelona

Vinyl murals were installed for Henry's walk through the many scenes shot in Barcelona, Spain.