

ATN

SUCCESSION

Episode 408 // America Decides

Stephen H. Carter // Production Design



AMERICAN TELEVISION NETWORK

ATN
NEWS

ATN
NEWS

Bullpen Concept Art

SUCCESSION

Episode 408 // America Decides
Stephen H. Carter // Production Design

Concept Art:



Still from Episode:



Still from Set:



2nd Floor // ATN Kitchen



1st Floor // Control Room "A" (Same Layout to Control Room "B")



1st Floor // Studio "B"



2nd Floor
Conference Room, Office Hallways, Kitchen

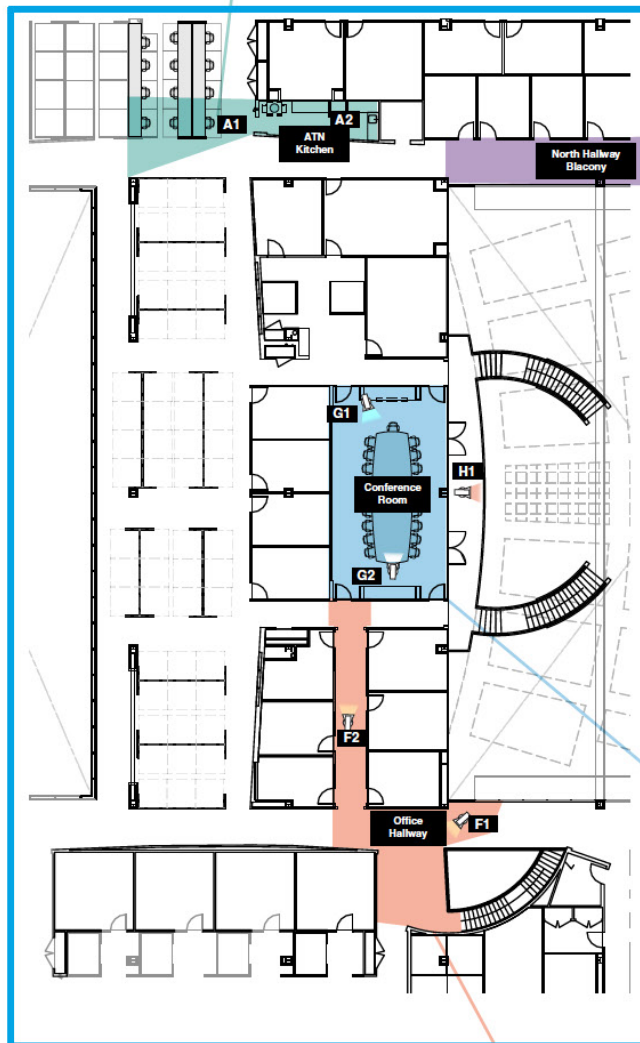

1st Floor
Bullpen, Control Rooms, and Studios

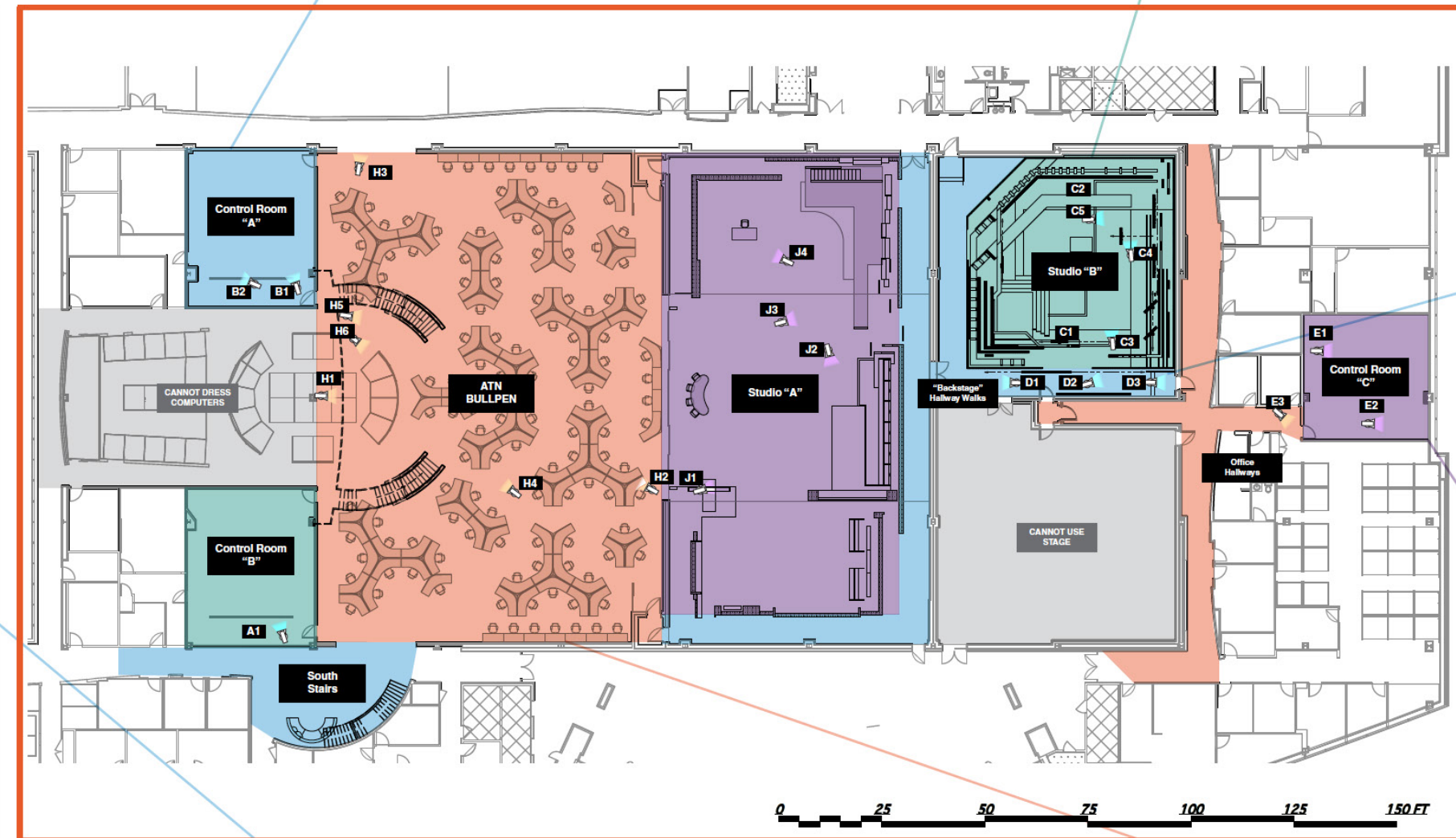

1st Floor // "Backstage" Hallway Walkthrough Outside of Studio "B"



1st Floor // Control Room "C"

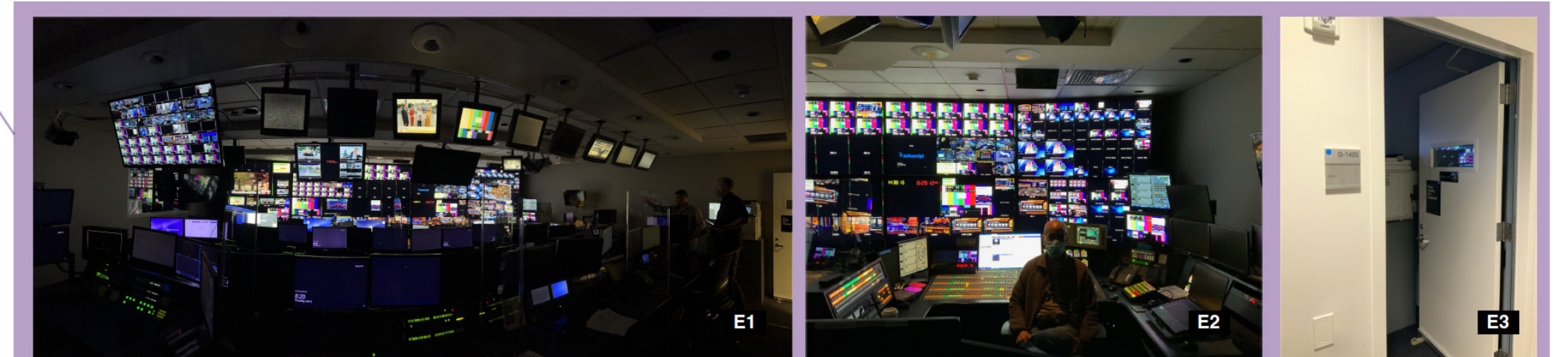

Conference Room, Office Hallways, Kitchen

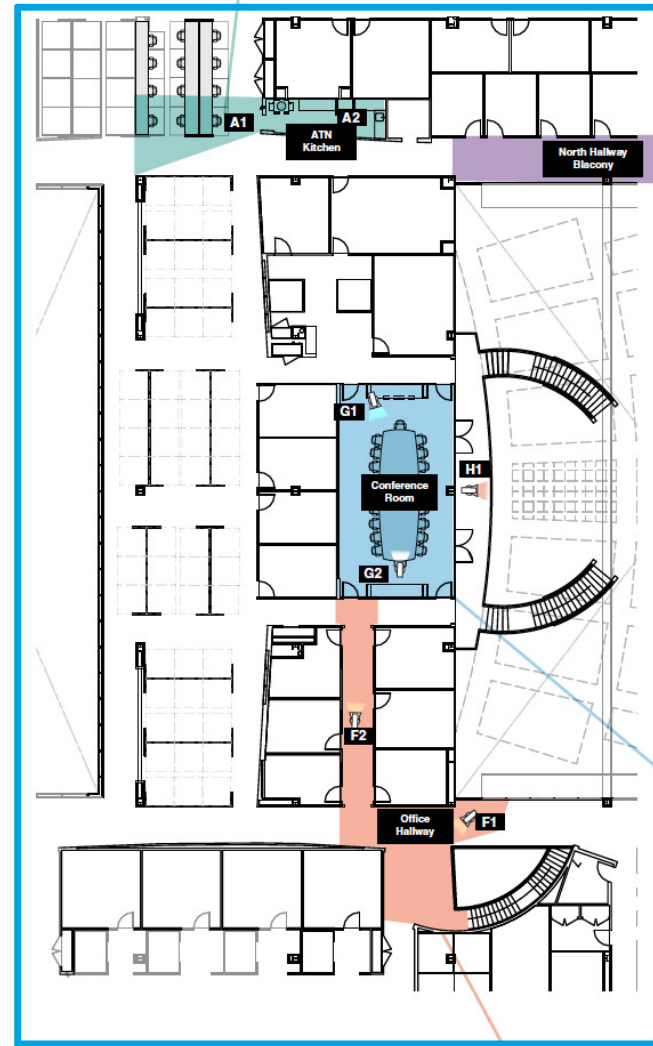

Bullpen, Control Rooms, and Studios

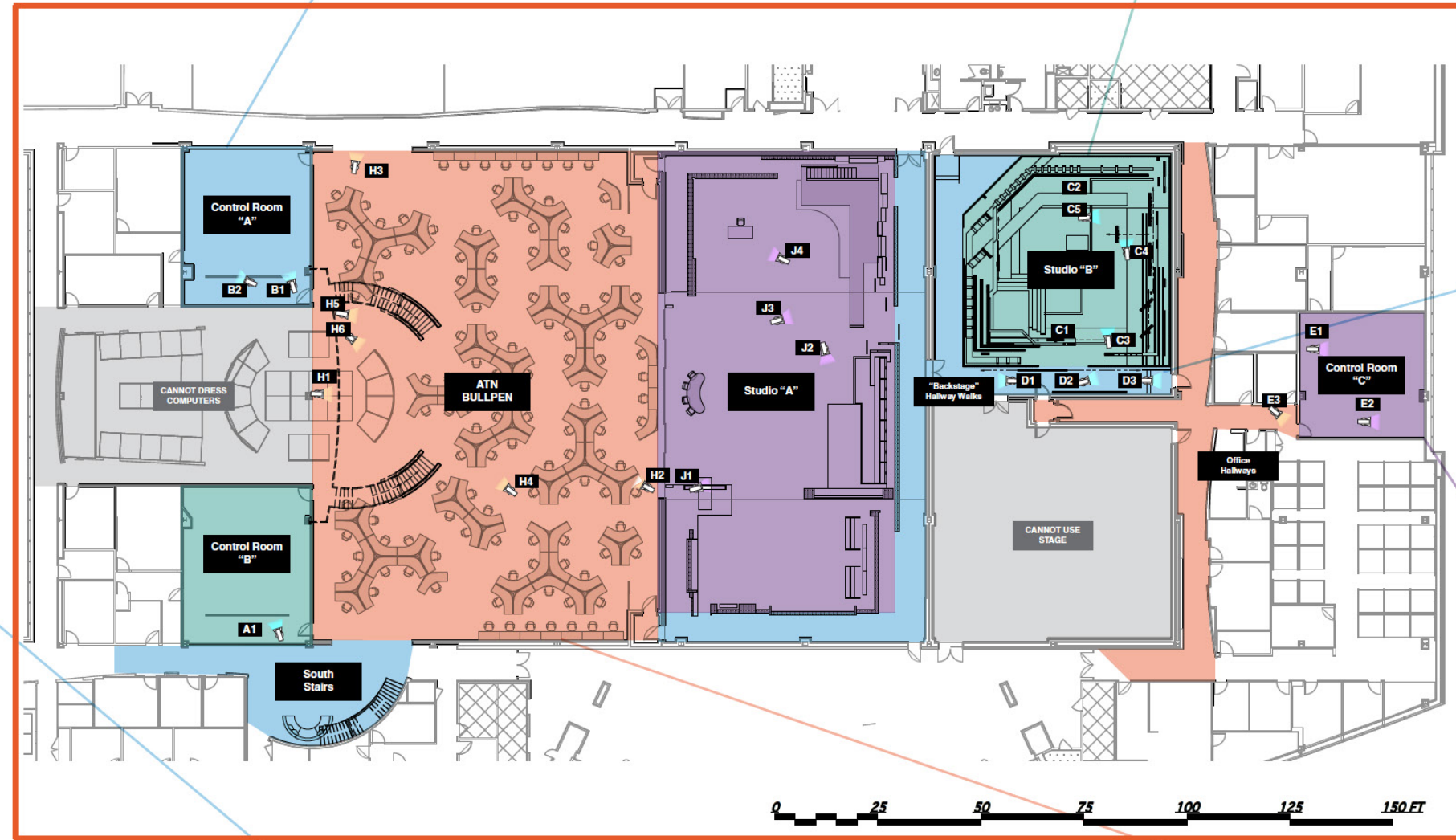

1st Floor // "Backstage" Hallway Walkthrough Outside of Studio "B"



1st Floor // Control Room "C"

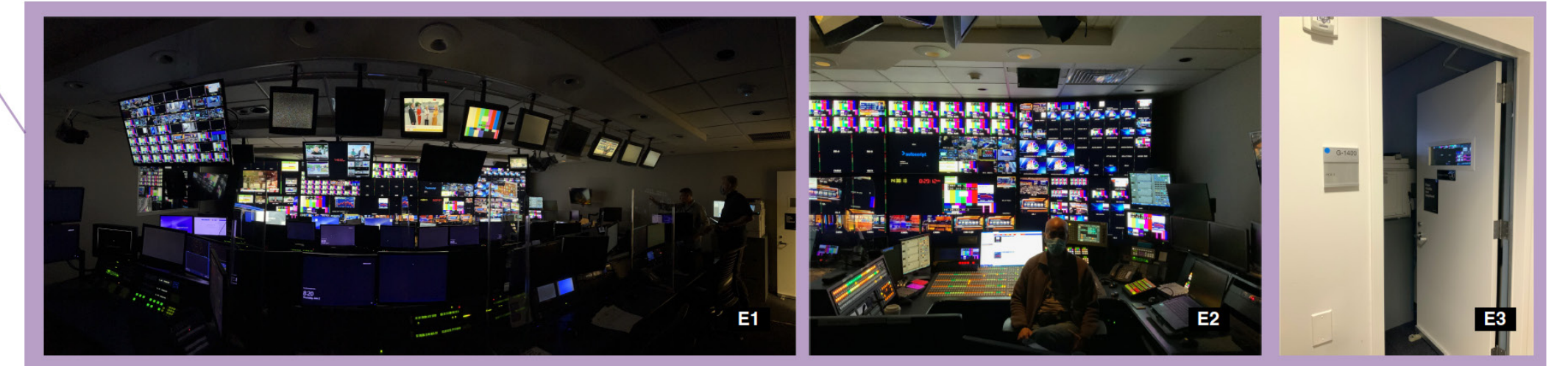

2nd Floor // Office Hallway to Stairs

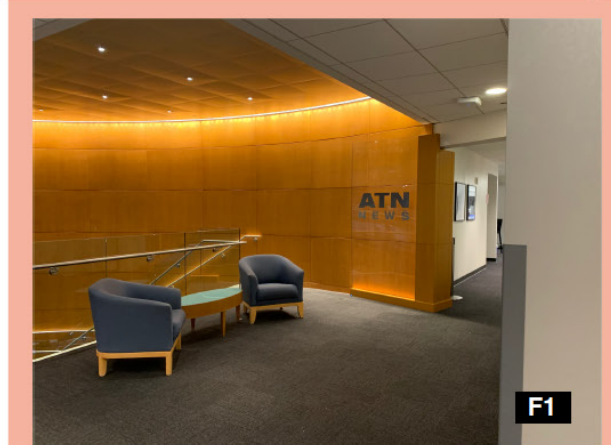

2nd Floor // Conference Room

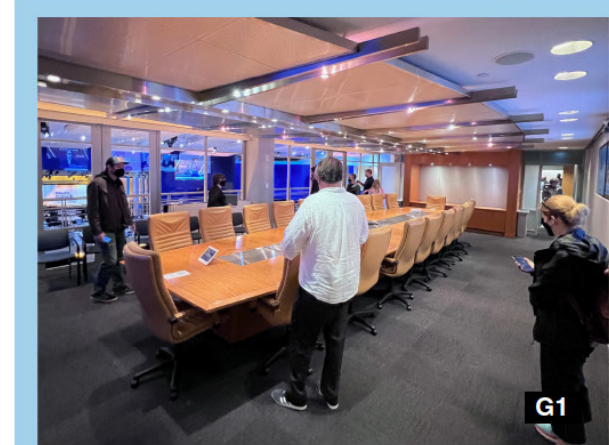

View of Studio "A" and Bullpen from Conference Room



Panoramic View of Bullpen & Studio "A" from Stage Door



Studio "A"

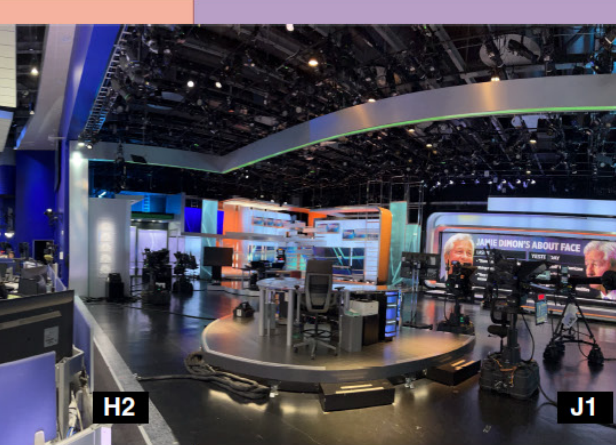

Studio "A" // Big Screen

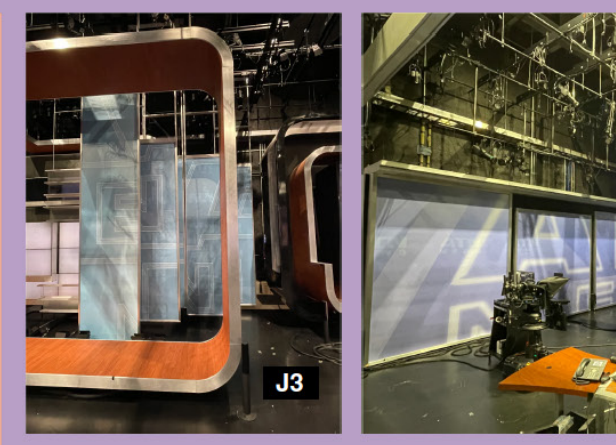
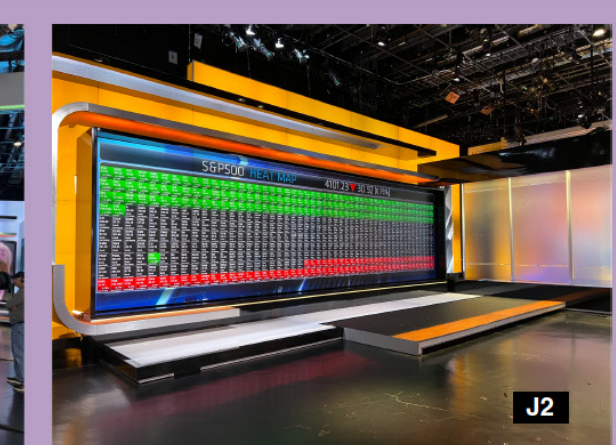

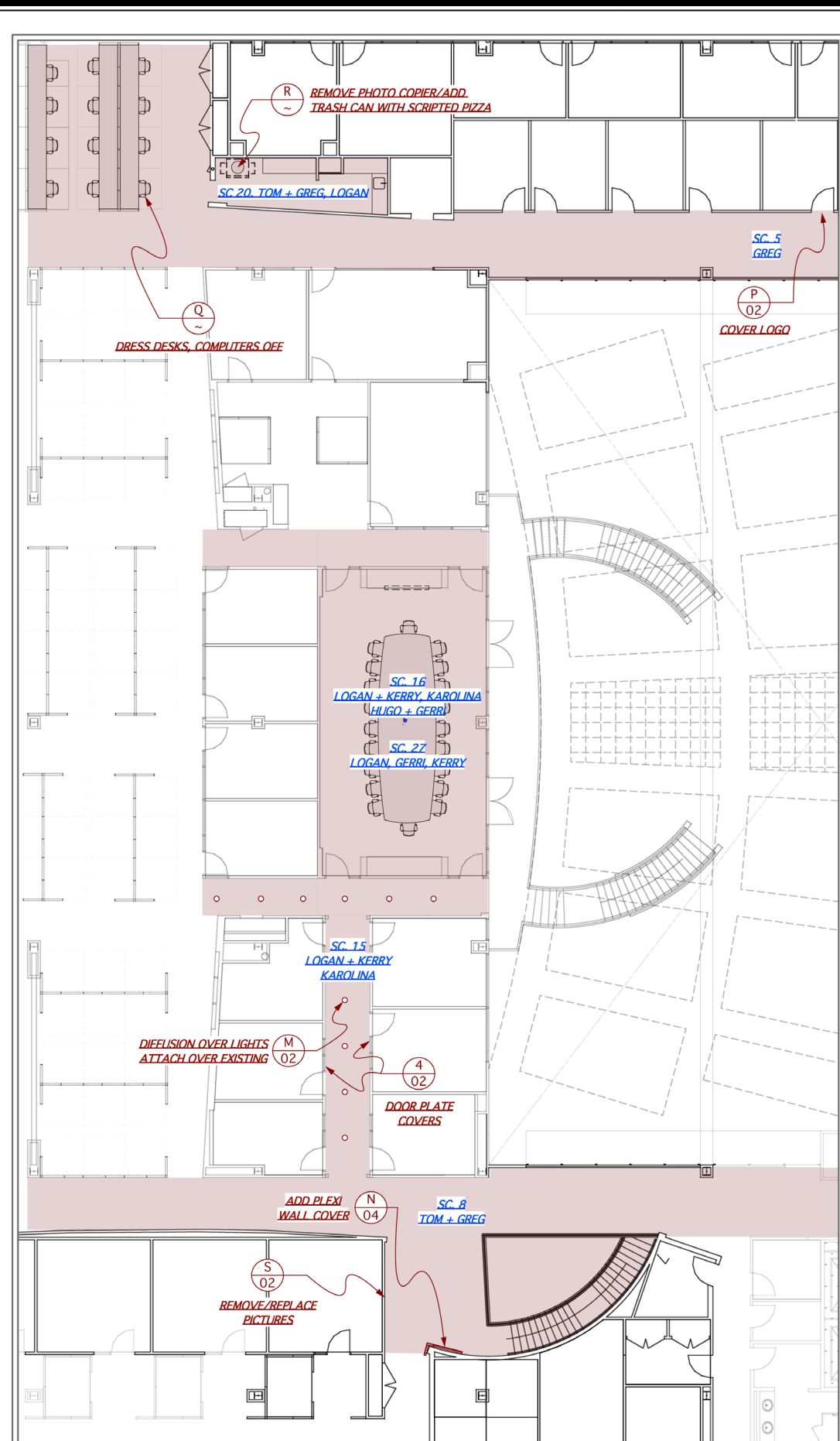

B-B LOCATION PLAN (SECOND FLOOR) - INT ATN, CONFERENCE ROOM
Scale: 3/32" = 1'-0"

RED HIGHLIGHT PLAYS IN EP 402
ALL AREAS NOT HIGHLIGHTED ARE OFF CAMERA

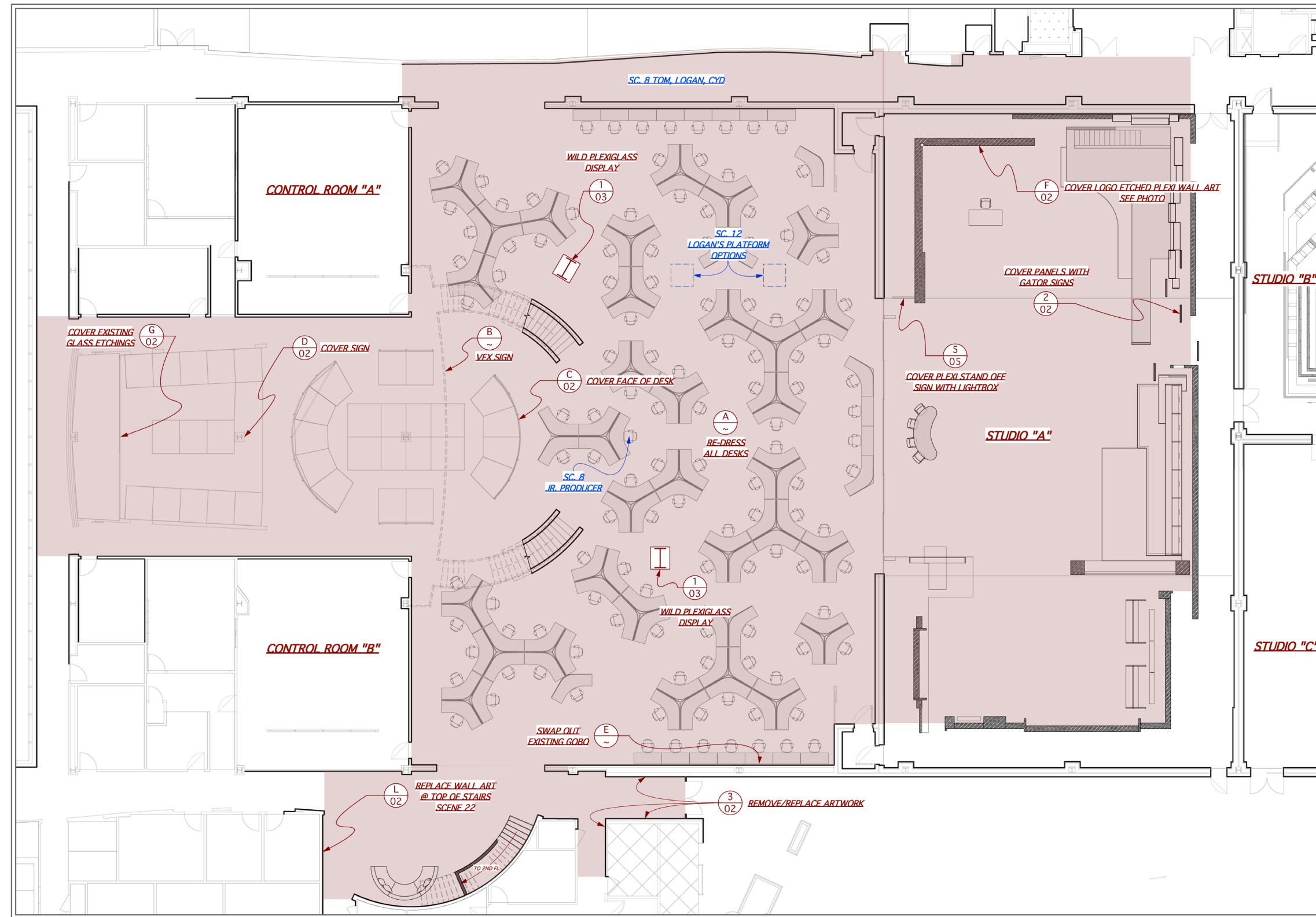

A-A LOCATION PLAN (1ST FLOOR) - INT ATN, BULLPEN, STUDIO
Scale: 3/32" = 1'-0"

SCENE SCHEDULE:

SC. 5	ATN BULLPEN + VANTAGE POINT - GREG + LOGAN
SC. 8	ATN HALLWAY - TOM, LOGAN, CYD BULLPEN - JR PRODUCER
SC. 12	ATN BULLPEN (platform) - LOGAN, CYD, TOM
SC. 15	ATN HALLWAY - LOGAN + KERRY, KAROLINA
SC. 16	ATN CONFERENCE ROOM - LOGAN + KERRY, KAROLINA, HUGO + GERRI
SC. 20	ATN KITCHEN - TOM + GREG, LOGAN
SC. 27	ATN CONFERENCE ROOM - LOGAN, GERRI, KERRY

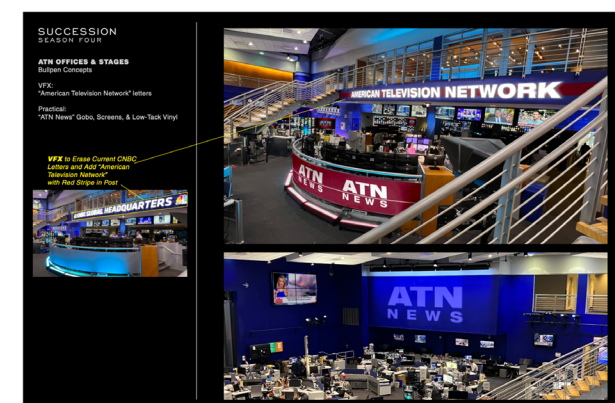

ILLUSTRATION - INT ATN

ADDED SCOUT NOTES
SHOWS 402 WORK ONLY
07-15-2022
REVISED

07-07-2022
RELEASED

SET # 4400
EPISODE 402

REVISIONS: AS NOTED
DRAWN BY: LR
DATE DRAWN:

SCALE: AS NOTED
LOCATION PLAN

SET NAME: INT ATN TV STUDIO - MAIN
DRAWING: LOCATION PLAN
LOCATION: CNBC STUDIO, ENGLEWOOD, NJ

PRODUCTION DESIGNER: STEPHEN CARTER
ART DIRECTOR: MICHAEL WILSON
PRODUCTION DESIGNER: SCOTT FERGUSON
DIRECTOR: MARK WYCOFF

MBD
Kathleen Ayles Studio - Burbank Productions, LLC
3415 24th St., Ft. Lauderdale, FL 33309
TEL: 754.326.6800
RECENT PRODUCTION: MARK WYCOFF - SCOTT FERGUSON
DIRECTOR: MARK WYCOFF

SUCCESSION
SEASON FOUR

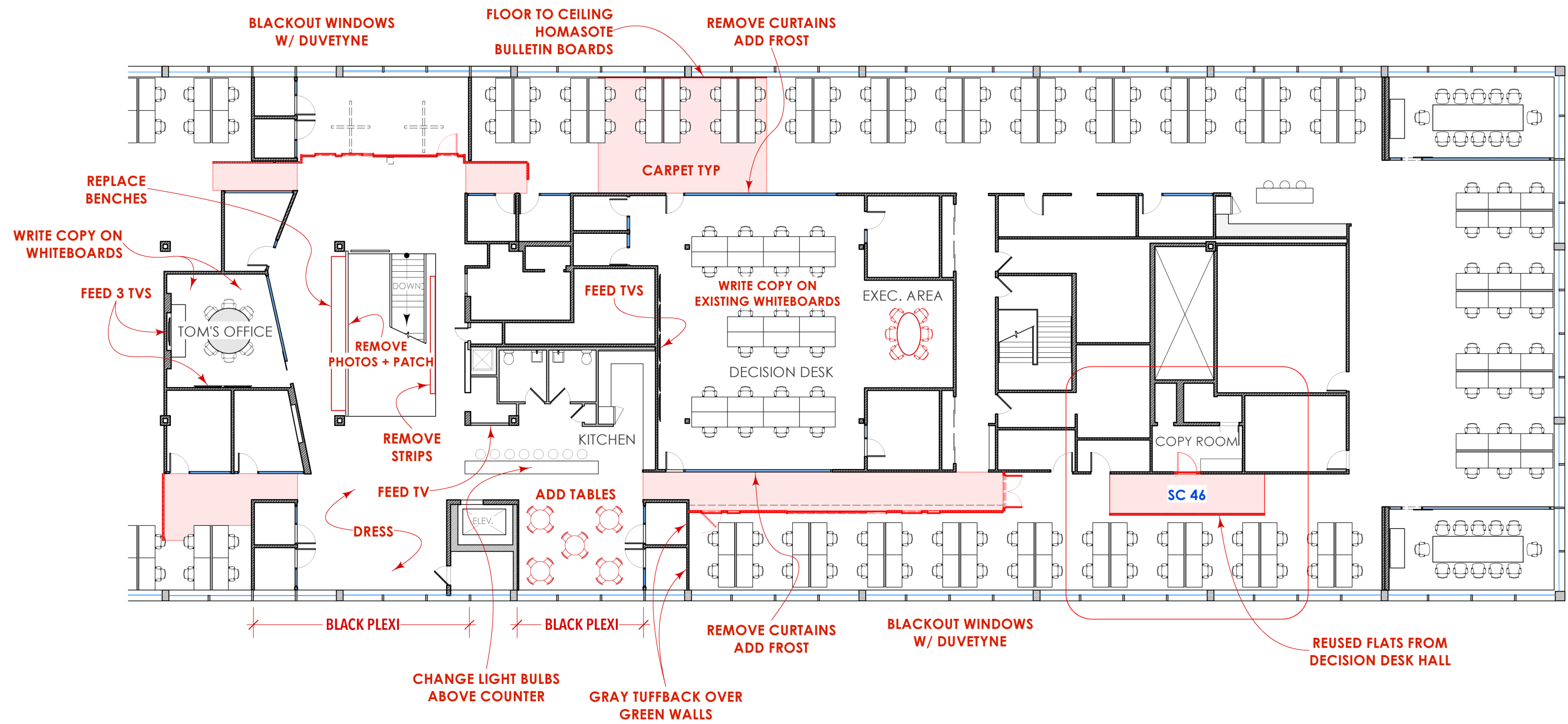

DP INT ATN (NBCU - 2nd FL)
 Scale: 1/16" = 1'-0"



SUCCESSION SEASON FOUR	HBD Kaufman Astoria Studio - Sourdough Productions, LLC 34-12 36th St, 3rd Floor Astoria, NY 11106 718-706-5850	PROD DESIGNER: STEPHEN CARTER ART DIRECTOR: MOLLY MIKULA SET DECORATOR: GEORGE DETITTA CONST COORD: MIKE DAVIDSON ART DEPT: (718) 706-4773	SET NAME: INT ATN - TOM'S OFFICE, DECISION DESK, EXEC. AREA, HALLS/KITCHEN, COPY ROOM DRAWING: DIRECTOR'S PLAN - NBCU 2ND FLOOR LOCATION: NBCU - 904 SYLVAN AVE - 2ND FLOOR, ENGLEWOOD CLIFFS, NJ	SCALE: AS NOTED DRAWN BY: ER DATE DRAWN: 12/07/22	REVISIONS:	SET #: 4405/6, 4809 EPISODE: 408	SHEET #: DP
	E.P./CREATOR: JESSE ARMSTRONG PRODUCER: GABRIELLE MAHON E.P./DIRECTOR: MARK MYLOD						

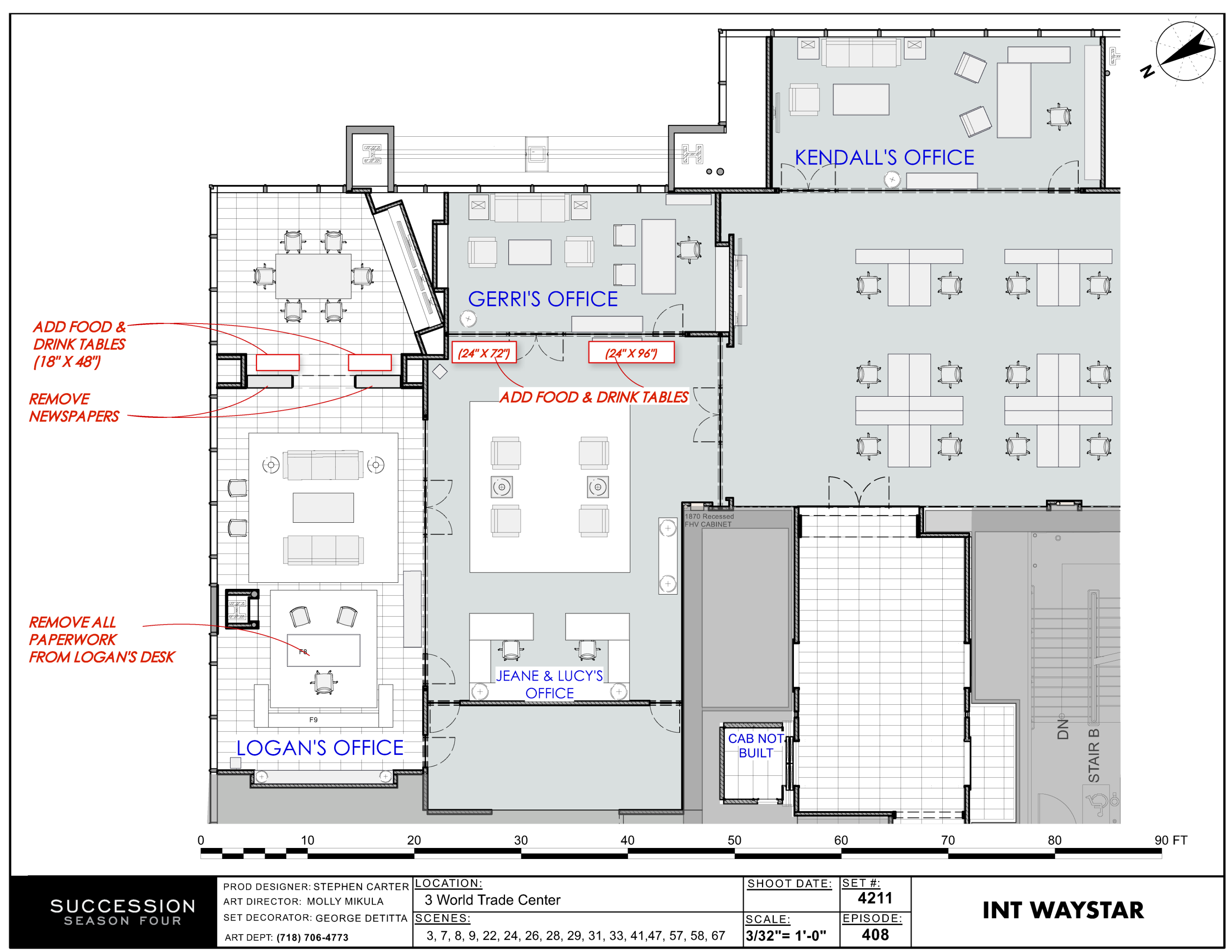

SUCCESSION
SEASON FOUR

PROD DESIGNER: STEPHEN CARTER
ART DIRECTOR: MOLLY MIKULA
SET DECORATOR: GEORGE DETITTA
ART DEPT: (718) 706-4773

LOCATION:
3 World Trade Center
SCENES:
3, 7, 8, 9, 22, 24, 26, 28, 29, 31, 33, 41, 47, 57, 58, 67

SHOOT DATE:
SET #:
4211
SCALE:
3/32" = 1'-0"
EPISODE:
408

INT WAYSTAR



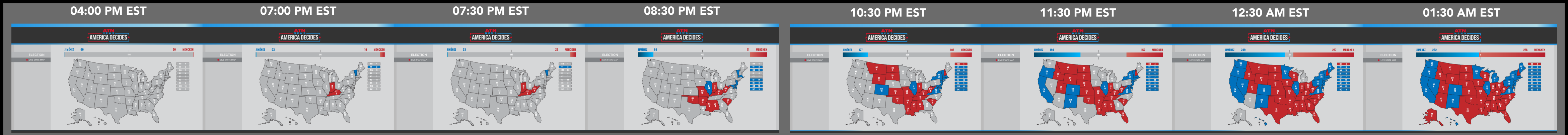

SOURDOUGH SEASON FOUR 408 // ATN Decision Desk White Board Content // 12.06.22

ATN VOTING REPORTERS

STATE	BATTLEGROUND REP.	CITY
NORTH CAROLINA	B. HUNTER & A. BYRNES	RALEIGH & CHARLOTTE
FLORIDA	M. MILLER & R. KAHN	TALLAHASSEE & BROWARD CO.
PENNSYLVANIA	R. PRICE & M. FREEMAN	HARRISBURG & PHILLY
MICHIGAN	T. WYNN & J. MICHAELS	LANSING OR DETROIT
WISCONSIN	T. HASSAN & O. KROLL	MADISON OR MILWAUKEE
ARIZONA	R. HARVEY	PHOENIX
OHIO	E. WALKER & J. YOUNG	CLEVELAND & COLUMBUS
GEORGIA	D. KIRSCH & P. THOMPSON	ATLANTA
MAINE 2	B. CHEN	BANGOR ME
NEW HAMPSHIRE	J. BAILEY	NASHUA
MINNESOTA	M. GONZALEZ	ST. PAUL
TEXAS	S. LEE & R. ROBINSON	HOUSTON & AUSTIN
IOWA/NEBRASKA 2	B. FIELDS	DES MOINES
NEVADA	S. BRINKERHOFF	LAS VEGAS
BUREAU CITIES - VOTING	REPORTER	CITY
NORTH CAROLINA	J. ALEXANDER & M. GORDON	LOS ANGELES
FLORIDA	B. STEWART & A. BAKER	NEW YORK CITY
PENNSYLVANIA	S. KAUFMAN & M. BRUCE	ARLINGTON OR ALEXANDRIA



SOURDOUGH SEASON FOUR 408 // ATN Decision Desk White Board Content // 12.06.22

Poll Closing (EST)

NO STATE EXIT POLL

7pm GA, IN (partial), KY (partial), SC, VT, VA	9pm AZ, CO, KS (partial), LA, MI, MN, NE (CD 1, 2 and 3), NM, NY, ND (partial), SD, TX (partial), WI, WY
7:30pm NC, OH, WV	
8pm AL, CT, DE, DC, FL (partial), IL, ME (CD 1 and 2), MD, MA, MS, MO, NH (partial), NJ, OK, PA, RI, TN	10pm IA, MT, NV, UT
8:30pm AR	11pm CA, ID, OR, WA
	12pm HI
	1am AK

ATN NEWS - PRESIDENTIAL ELECTION COVERAGE

	ARKANSAS	ARIZONA	COLORADO	KANSAS	LOUISIANA	MICHIGAN	MINNESOTA	NEBRASKA	NE CD-1	NE CD-2	NE CD-3	NEW MEXICO	NEW YORK	N. DAKOTA	S. DAKOTA	TEXAS	WISCONSIN	WYOMING	IOWA	MONTANA	NEVADA	UTAH	CALIFORNIA	IDAHO	OREGON	WASHINGTON	HAWAII	ALASKA	EVs
8:30 PM	Mencken	Jimenez																											6
		1:05 AM	10:23 PM	9:55 PM	9:12 PM	12:50 AM	12:13 AM	10:49 PM	10:49 PM	10:49 PM	10:49 PM	10:42 PM				12:14 AM	12:23 AM		12:09 AM		12:07 AM	11:12 PM				11:07 PM	11:38 PM		
9 PM																													
10 PM																													
11 PM																													
12 PM																													
1 AM																													

*No State Exit Poll

ATN NEWS - PRESIDENTIAL ELECTION COVERAGE



SUCCESSION
SEASON FOUR
02 // ATN ELECTION
COVERAGE GRAPHICS
INFO NEEDED
03
DNC and RNC Fundraising Numbers

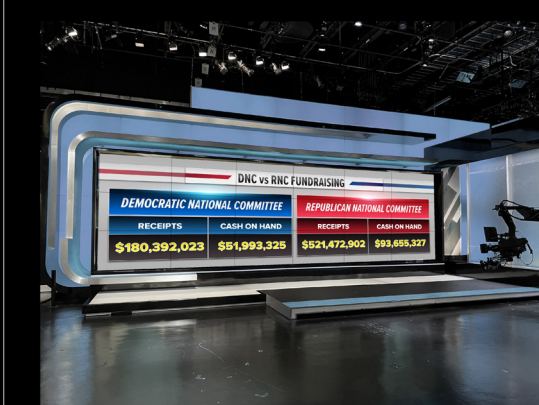

SUCCESSION
SEASON FOUR
01
02 // ATN ELECTION
COVERAGE GRAPHICS
INFO NEEDED
01
Polling Numbers for the Candidates
Control US &
Background States

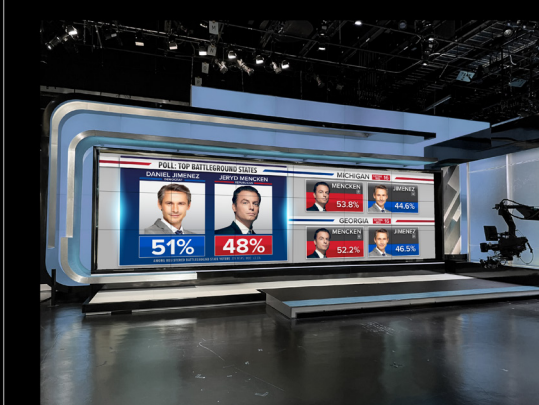

SUCCESSION
SEASON FOUR
01
01
POLL BY MAJORITY STATES

SUCCESSION
SEASON FOUR
02
02 // ATN ELECTION
COVERAGE GRAPHICS
INFO NEEDED
02
Top Issues for Voters
and Funding Numbers

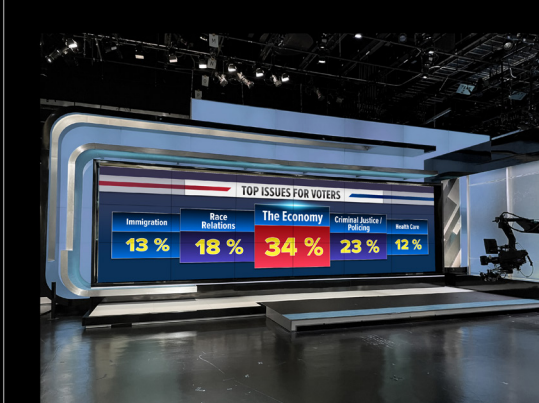



NOVEMBER
SWING STATES STOP ACCEPTING
PRE-ELECTION DAY VOTES

TIMELINE
5pm: FIRST EXIT PUS
6pm: FIRST RESULTS (KY/IN)
7pm: FIRST POLLS CLOSE

NEXT POLLS CLOSE
7:30pm 6pm 8:30pm
9pm 10pm 11pm
12am 1am

WHEN BALLOTS
WILL BE COUNTED

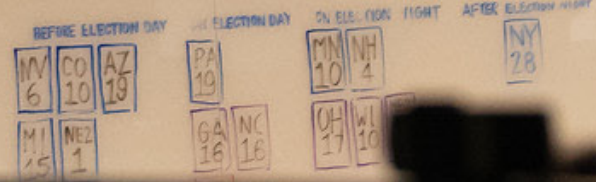

TIMELINE

5:00PM FIRST EXIT PUS
6:00PM FIRST RESULTS (KY/IN)
7:00PM FIRST POLLS CLOSE

NEXT POLLS CLOSE:
7:30PM 8:00PM 8:30PM
9:00PM 10:00PM 11:00PM
12:00AM 1:00AM

SUCCESSION

Episode 408 // America Decides
Stephen H. Carter // Production Design

