

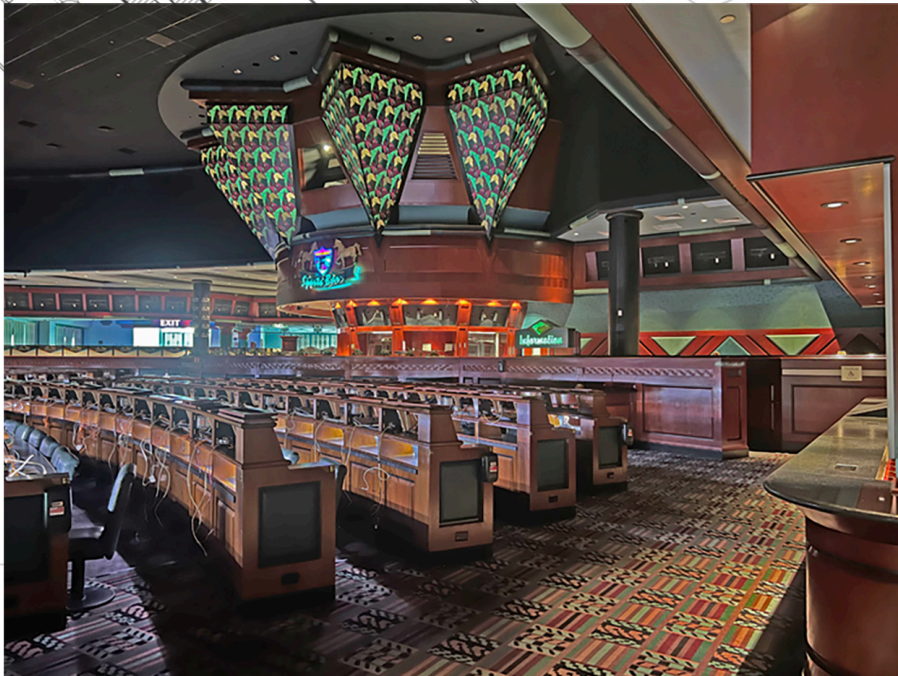

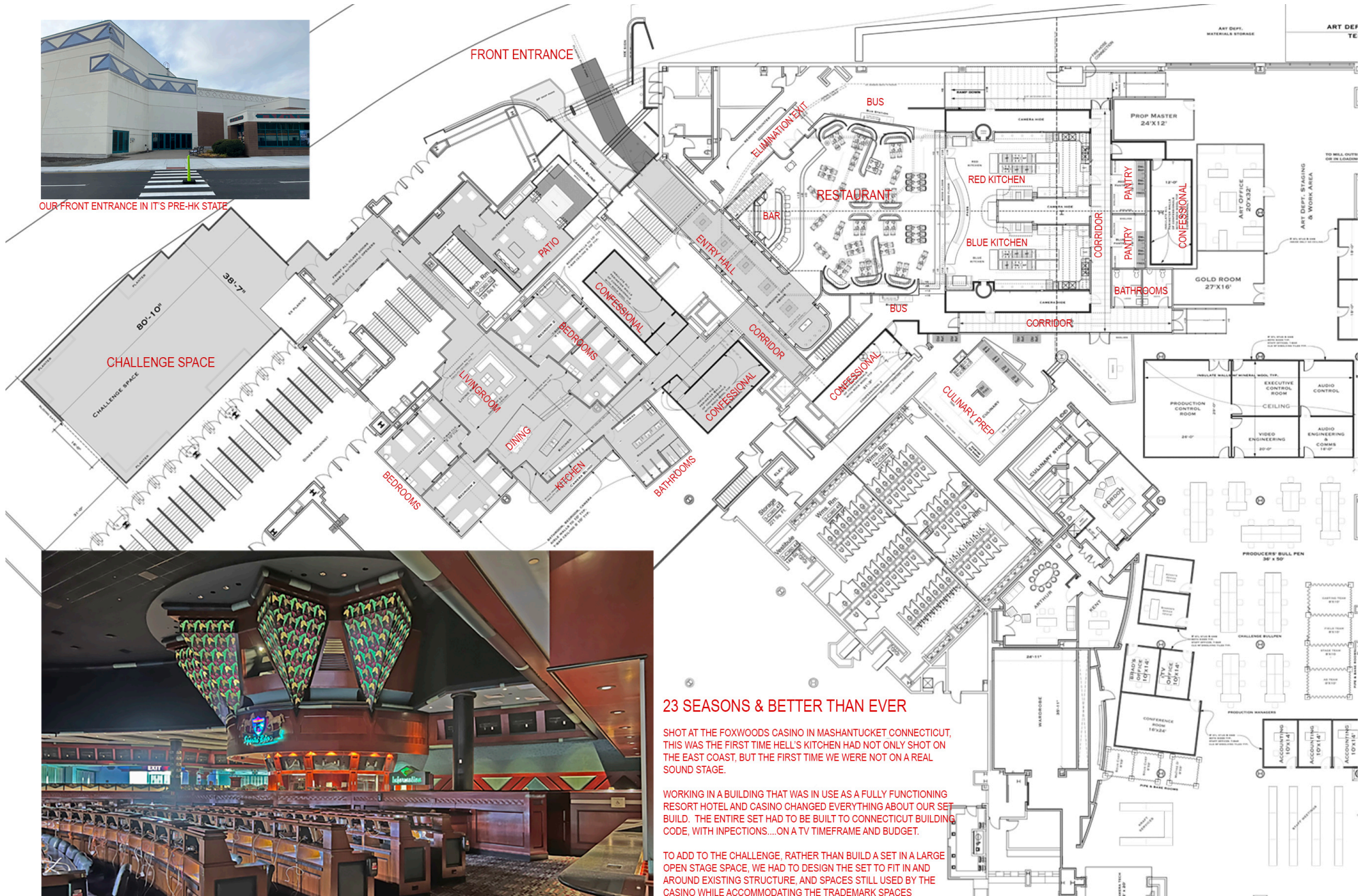



OUR FRONT ENTRANCE IN ITS PRE-HK STATE



OUR "SOUND STAGE" BEFORE DEMOLITION. THE ART DEPARTMENT HAD TO SPECIFY AND OVERSEE DEMOLITION OF OVER 80,000 SF OF SPACE TO MAKE IT USABLE.

## 23 SEASONS & BETTER THAN EVER

SHOT AT THE FOXWOODS CASINO IN MASHANTUCKET CONNECTICUT, THIS WAS THE FIRST TIME HELL'S KITCHEN HAD NOT ONLY SHOT ON THE EAST COAST, BUT THE FIRST TIME WE WERE NOT ON A REAL SOUND STAGE.

WORKING IN A BUILDING THAT WAS IN USE AS A FULLY FUNCTIONING RESORT HOTEL AND CASINO CHANGED EVERYTHING ABOUT OUR SET BUILD. THE ENTIRE SET HAD TO BE BUILT TO CONNECTICUT BUILDING CODE, WITH INSPECTIONS...ON A TV TIMEFRAME AND BUDGET.

TO ADD TO THE CHALLENGE, RATHER THAN BUILD A SET IN A LARGE OPEN STAGE SPACE, WE HAD TO DESIGN THE SET TO FIT IN AND AROUND EXISTING STRUCTURE, AND SPACES STILL USED BY THE CASINO WHILE ACCOMMODATING THE TRADEMARK SPACES AND PROGRAM OF THE SHOW IN 21 CONTINUOUS FOUR WALL SETS ALL TIED TOGETHER SEAMLESSLY.

NOT EASY.

BUT WITH A GREAT ART DEPARTMENT TEAM ANYTHING CAN BE DONE. TAKE A LOOK.







### THE ARRIVAL

WE SERVE A REAL 5 STAR DINING EXPERIENCE TO 84 PATRONS AT EVERY DINNER SERVICE. TO THEM, THIS IS A REAL PLACE, NOT A SET. EVERY SPACE IN THE SET IS A CONTINUOUS EXPERIENCE. THERE IS NO BACK STAGE FOR THE CAST OR DINERS. EVERYTHING IS AND MUST BE SHOOTABLE AT ALL TIMES. AND IT MUST BE BEAUTIFUL AND DRAMATIC.

THAT'S WHY WE HAVE A 48 FOOT LONG FLAMING PITCHFORK AT THE FRONT DOOR.

WELCOME TO HELL'S KITCHEN.





# THE RESTAURANT





# THE KITCHENS

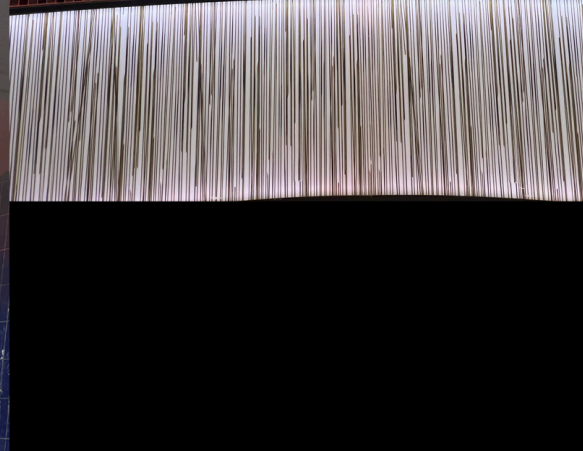



# THE LIVING QUARTERS

