



RALPH FIENNES  
STANLEY TUCCI  
JOHN LITHGOW  
AND  
ISABELLA ROSSELLINI

# CONCLAVE

FROM ACQUITTAL TO THE FRONT  
DIRECTED BY PAUL QUINN

WHAT HAPPENS BEHIND THESE WALLS  
WILL CHANGE EVERYTHING.

ONLY IN THEATERS OCTOBER 25

# PRODUCTION DESIGN PRESENTATION

A Conclave is often shrouded in mystery and discretion - we know the tradition but do we really know what occurs behind the closed Sistine Chapel doors ? Making the most of Rome and the fabulous Cinnecitta Studios we decided to explore faith power and intrigue for this particular design interpretation.

Whilst the Sistine chapel is well documented the other areas of the Vatican our Cardinals inhabit in Conclave is less so . So a sense of confinement was created in the almost prison like Casa Santa Marta - hopefully enhancing the feeling of secrecy and tension. Long narrow corridors and dark corners add to the stress and symbolise the pressure and isolation of the decision making process. The intensity was felt by the construction and art department teams too ! ... we only had one studio available to us at Cinnecitta - so every spare corner was utilised in Stage 15 - housing the Sistine Chapel and Casa Santa Marta builds. The construction and painting teams were incredible and repainting the Sistine Chapel was a challenge they completely rose too . Rome locations were also used and augmented to create the jigsaw of our Vatican City.

We wanted the film to be a balance of juxtapositions - contemporary and historical, sacred and political, light and shadow, ornate and brutal. The colour palette enabled the extraordinary robes created by Costume Designer Lisy Crystl to stand out against the more somber colours especially in the municipal areas - the canteen, the private rooms , the hallways etc. As always a film is a collaboration with all the other departments and we became a tight team during this shoot to achieve Edwards vision.

Suzie Davies

Production Designer Oct 2024



**CONCLAVE**

DIRIGED DA

**Edward Berger**

Sistine Chapel















# CONCLAVE

CSM 022  
000

CASA SANTA MARTA | STAGE 15 | PAFAL SUITE DRESSING PLAN | 1:50 @ A3

## PAPAL SUITE

SHOT DATE:

FRIDAY 24th FEB  
24/02/2023

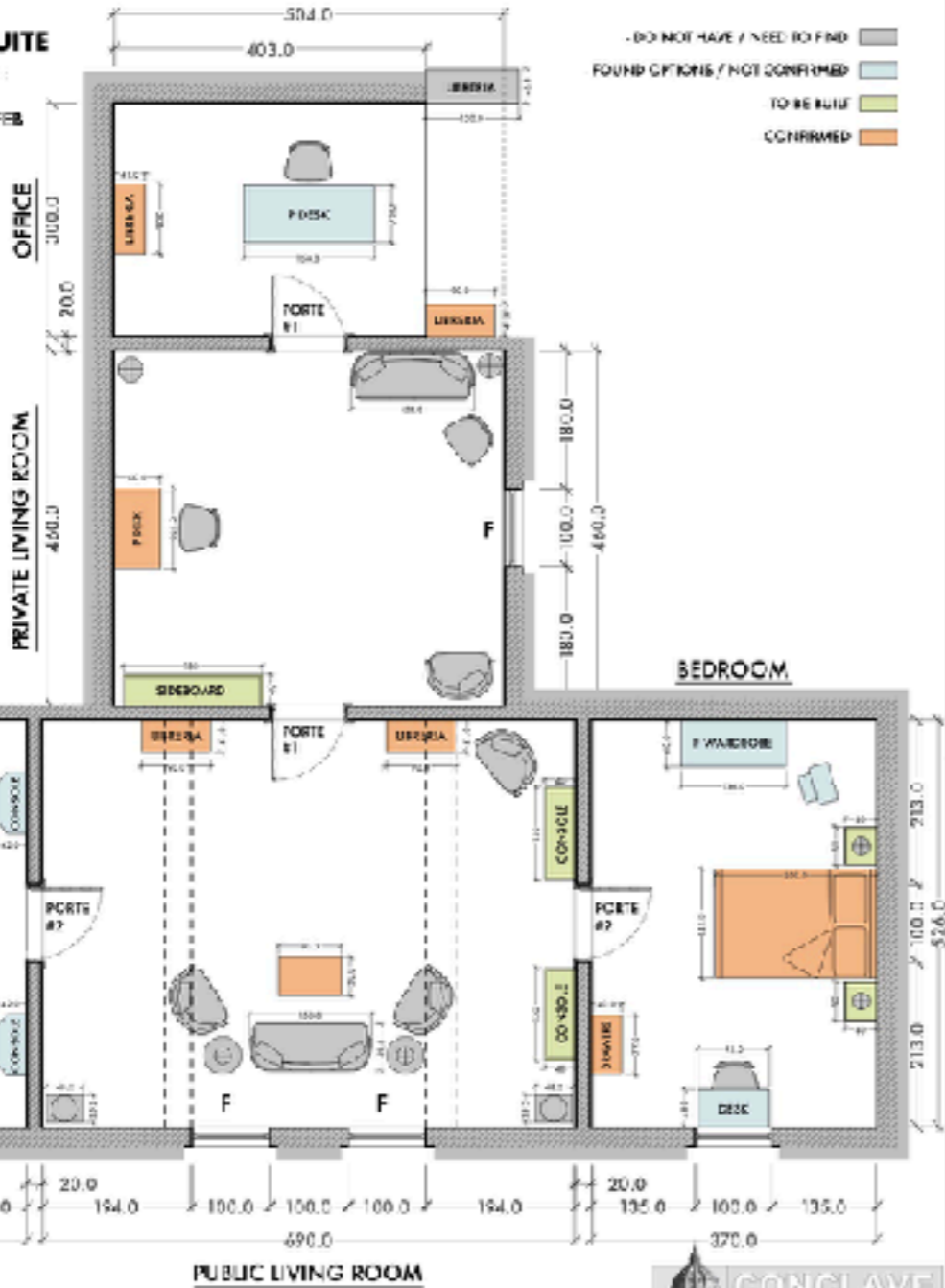

6. PLAN @ 1:50

25.11.22  
REVISION

**CONCLAVE**

PROJECT NUMBER	022
STAGE	15
DATE	25.11.22
SCALE	1:50
DESIGNER	CSM
PROJECT NAME	CONCLAVE
PLAN TYPE	DRESSING PLAN



BALLWAY









