

Based on a novel by
Ólafur Jóhann Ólafsson

Touch

by Baltasar
Kormákur

Locations:
- Iceland
- London
- Japan

RUK Studios AND Good Chaos

Touch
by Baltasar
Kormákur

Icelandic Countryside Ingjaldshöf skúlija, Snæfellsnes



Iceland
2020

Ext. Iceland countryside

Touch
by Baltasar
Kormakur

Grundafjörður Snefellsnes

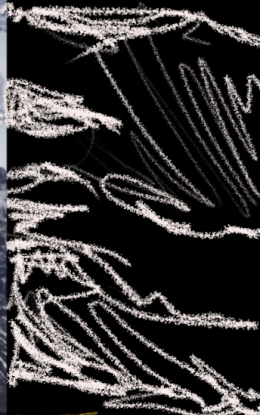

Iceland
2020



EXT. Grundafjörður



Touch
by Baltasar
Kormakur

Torg Restaurant

Bjargsteinn Grindavíki



Iceland
2020

INT. Torg Restaurant.

Touch
by Baltasar
Kormákur

Retirement home

Dvalarheimili Aldrabra, Reykjavík



Iceland
2020



Ext. Retirement home.

Touch
by Baltasar
Kormákur

Grundafjörður Church

Grampa Kirkejan, Stykkishölmur



Iceland
2020



INT. Grundafjörður Church

Touch
by Baltasar
Kormákur

Kristofer's home
Spítalastigur 3



Iceland
2020

INT. Kristofer's home

Touch
by Baltasar
Kormákur

Icelandic countryside
smefellnes



Iceland
2020

Ext. Icelandic countryside
to Keflavík Airport

Touch
by Baltasar
Kormákur

NIPPON

Gufunes Studio

Flashback



やきとり 一
 日本酒 三
 やきとり 一
 日本酒 三
 やきとり 一
 日本酒 三
 やきとり 一
 日本酒 三
 やきとり 一
 日本酒 三
 やきとり 一
 日本酒 三
 やきとり 一
 日本酒 三
 やきとり 一
 日本酒 三

LONDON
1969

INT. NIPPON RESTAURANT

Touch
by Baltasar
Kormákur

LSE Building

Land Registry

Flashback



WE STRIKE FOR JUSTICE

NEEDS YOU AT LSE DEMOCRACY

TIME JUMP

Ext. LONDON SCHOOL OF ECONOMICS

1969

LONDON 2020

gettyimages

Touch
by Baltasar
Kormakur

PUB (by Nippon Street)

Grapeshot

Flashback



LONDON
1969

INT. PUB + Street

Touch
by Baltasar
Kormákur

London Hotel

Simpsons in the Brand

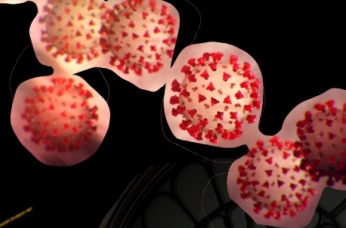

INT. Iceland
← Konsulat Hotel

LONDON
2020

INT. LONDON HOTEL
Reception



Touch
by Baltasar
Kormákur

LSE Library

Bishopsgate Institute

Flashback

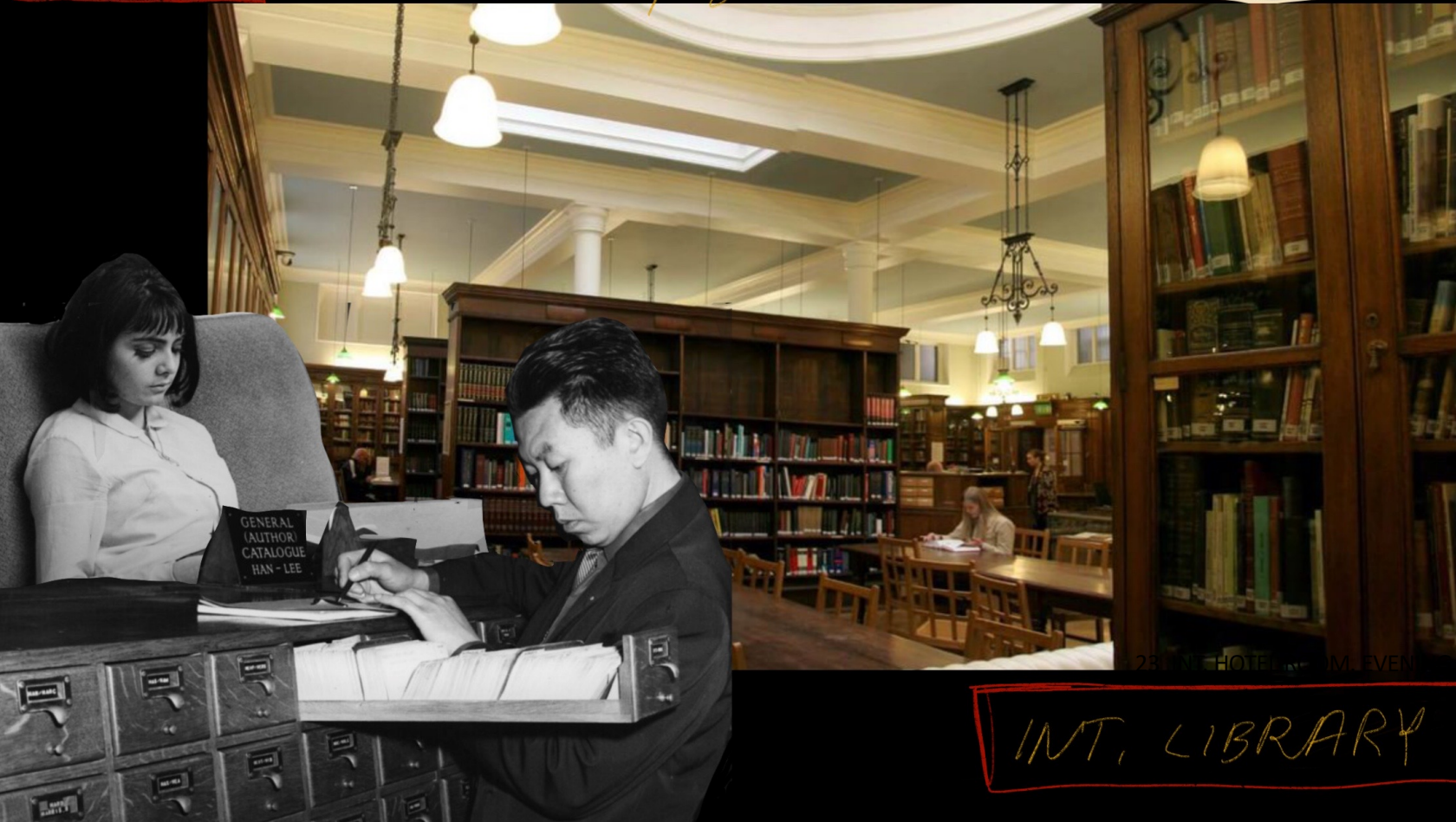

LONDON
1969

INT. LIBRARY

Touch
by Baltasar
Kormakur

勇

NIPPON
Artillery Passage



TIME
JUMP

Flashback



LONDON
2020

Ext. Nippon restaurant
+ London streets / Tatto Parlor

↓
1969

Touch
by Baltasar
Kormákur

Street Market Peacock Yard

Flashback



LONDON
1969

Ext. Market; Café;
Bookstore, Fishmonger

Touch
by Baltasar
Kormakur

Retirement home
Magwanie Way - Canary Wharf

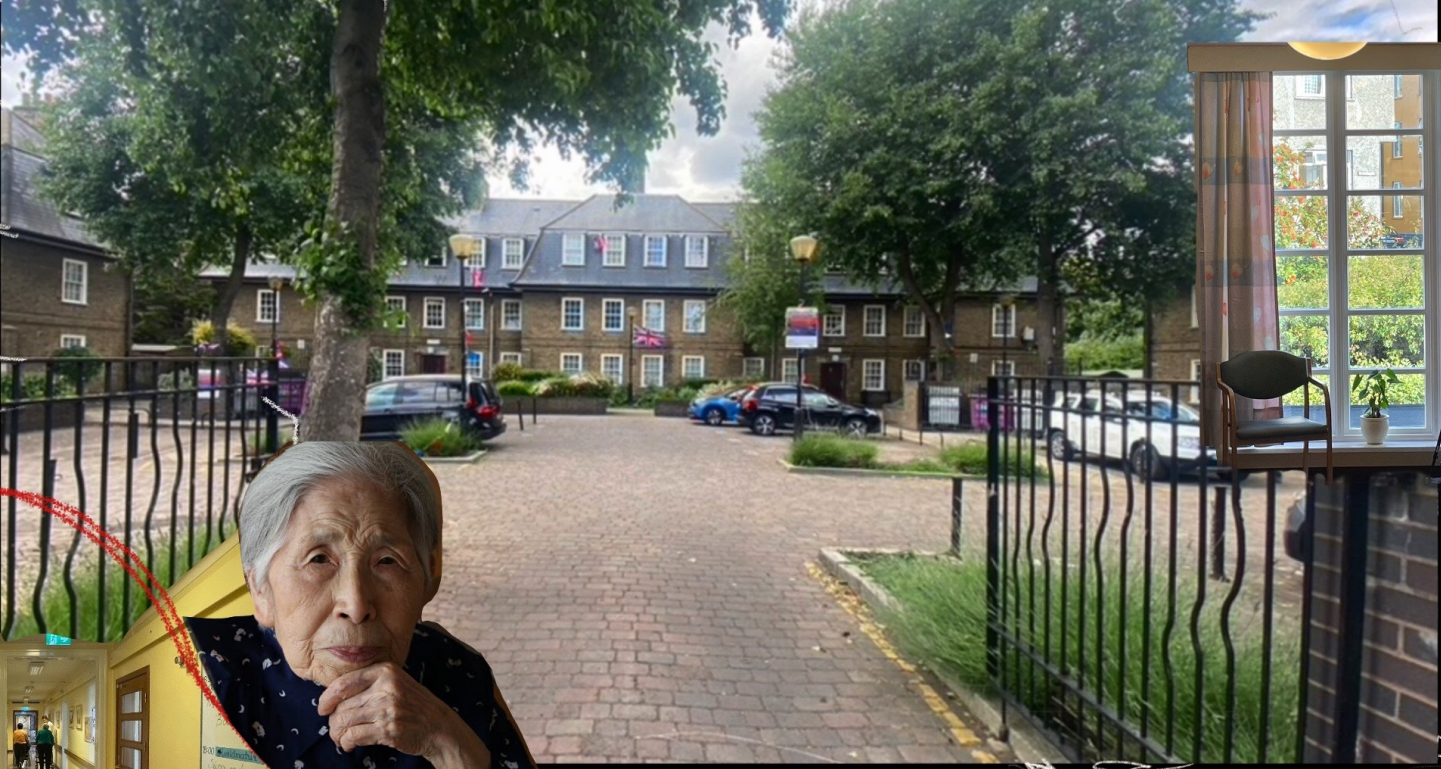
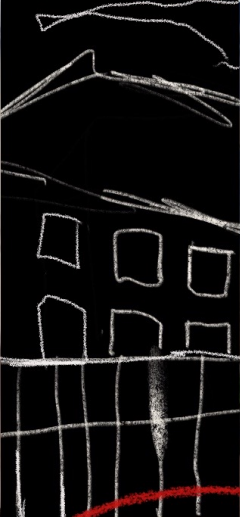

LONDON
2020



INT. Iceland
← GRUND

INT/Ext. London - Retirement
Home

Touch
by Baltasar
Kormákur

Krištofer's house Alderney Road



Flashback

LONDON
1969



INT. Iceland
← Gutunes

INT/EXT. Krištofer's house



Touch
by Baltasar
Kormakur

Miko's home

St. Peters Estate.



Flashback



LONDON
1969



INT. Iceland
← Gutunes

INT/EXT. small brick house

Touch
by Baltasar
Kormakur

JAL Airplane

Gutunes studio



LONDON
↓
JAPAN
2020

INT. JAL Airplane

Touch
by Baltasar
Kormákur

Tokyo Hotel

Hundred Stay room 20F



INT. Tokyo LOBBY
← Shinjuku Prince hotel

INT. Tokyo Hotel Room + Lobby

JAPAN
2020

Touch
by Baltasar
Kormakur

Tokyo City

Shibuya crossing + ABC Mart Shinjuku



JAPAN
2020

Ext. Tokyo streets and
shibuya shoe shop

Touch
by Baltasar
Kormakur

Tokyo walk to Restaurant

Kabukicho Ichibangji - Yasukuni/Don Quixote, Moa

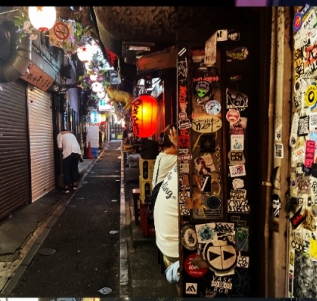

JAPAN
2020

Kyo Ome - Kaido avenue + Ext. Tokyo, Evening
Nishishinjuku

Touch
by Baltasar
Kormakur

Tokyo Restaurant

Kuisuke - Nishishinjuku



2020

85. INT. Tokyo Restaurant

Touch
by Baltasar
Kormakur

Karaoke Bar

Alita Bruce



JAPAN
2020

98. INT. BAR

Touch
by Baltasar
Kormakur

Sidewalk

Sinjuku - KABUKICHO - Golden Gai



JAPAN
2020

Ext. Tokyo Restaurant.
Sidewalk

Touch
by Baltasar
Kormakur

Bullett train

Bullett train to Hiroshima



JAPAN
2020

INT. Train. Day

Touch
by Baltasar
Kormak



Airbnb apartment Sakae



JAPAN
2020

Ext/Int. apartment building

Touch
by Baltasar
Kormakur

Flower Shop

Florist Yagi



JAPAN
2020

INT/EXT. Flower shop

Touch
by Baltasar
Kormakur

Miko's Apartment

New Horizon Matsumoto



JAPAN
2020

INT/Ext. Miko's apartment
building

Touch
by Baltasar
Kormákur

House in Harrow

Clerkenwell Flats

Flashback



LONDON
1969



INT. Iceland
← Heilsuvæðingarnótt

INT/EXT, House in Harrow

Touch
by Baltasar
Kormakur

Kure Restaurant

Kaki-Fune



JAPAN
2020

Ext/Int. Restaurant.

Based on a novel by
Ólafur Jóhann Ólafsson

Touch
by Baltasar
Kormákur

RUK Studios AND Good Chaos

NIPPON



veggflötur bakherbergi 54.5fm veggflötur eldhus 23.6fm

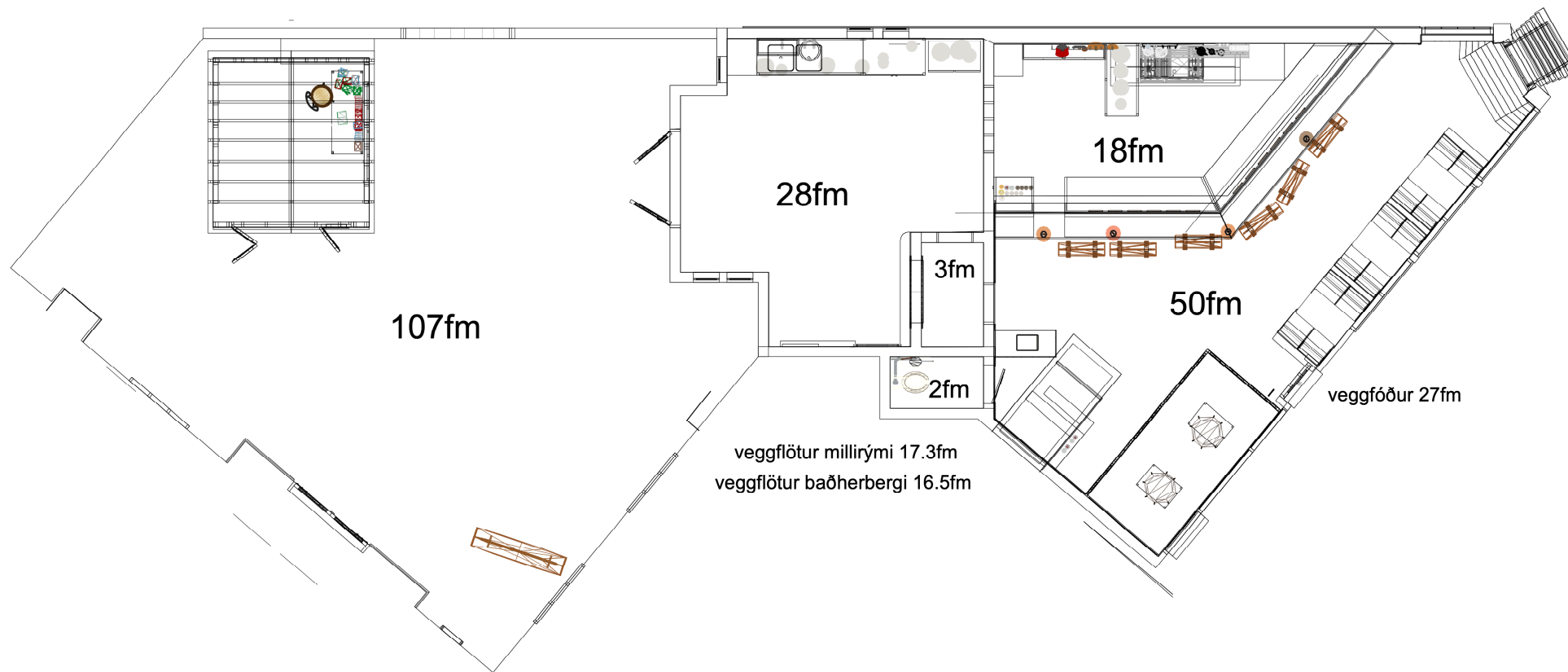







NIPPON RESTAURANT にっぽん

NIPPON RESTAURANT 日本





Japanese corner

