

MILEY CYRUS



BE AUNT
SOMETHING
TO GO

13 ORIGINAL SONGS
12 SHOOTING DAYS
3 SOUND STAGES
3 VMA NOMINATIONS

BEST ART DIRECTION | BEST CINEMATOGRAPHY | BEST LONG FORM VIDEO

WRITTEN & DIRECTED BY:

MILEY CYRUS
JACOB BIXENMAN
BRENDAN WALTER

CINEMATOGRAPHER
BENOÎT DEBIE

ART DEPARTMENT

PRODUCTION DESIGNER
DAVID MEYER

SET DECORATOR
ASHLEY SWANSON

ART DIRECTOR
GORDON STOTZ

PROPERTY MASTER
TODD DANIELS

SET DESIGNER
KATHERINE SHARPLESS

CONSTRUCTION COORDINATOR
JEFF SHEWBERT - REEL SETS

ART DEPT. ASSISTANT
GRACE HINDLE

STORYBOARD ARTIST
SAM HUDECKI

A ONE OF A KIND

P

FUELED

O

BY

P

FANTASY

E

R

A



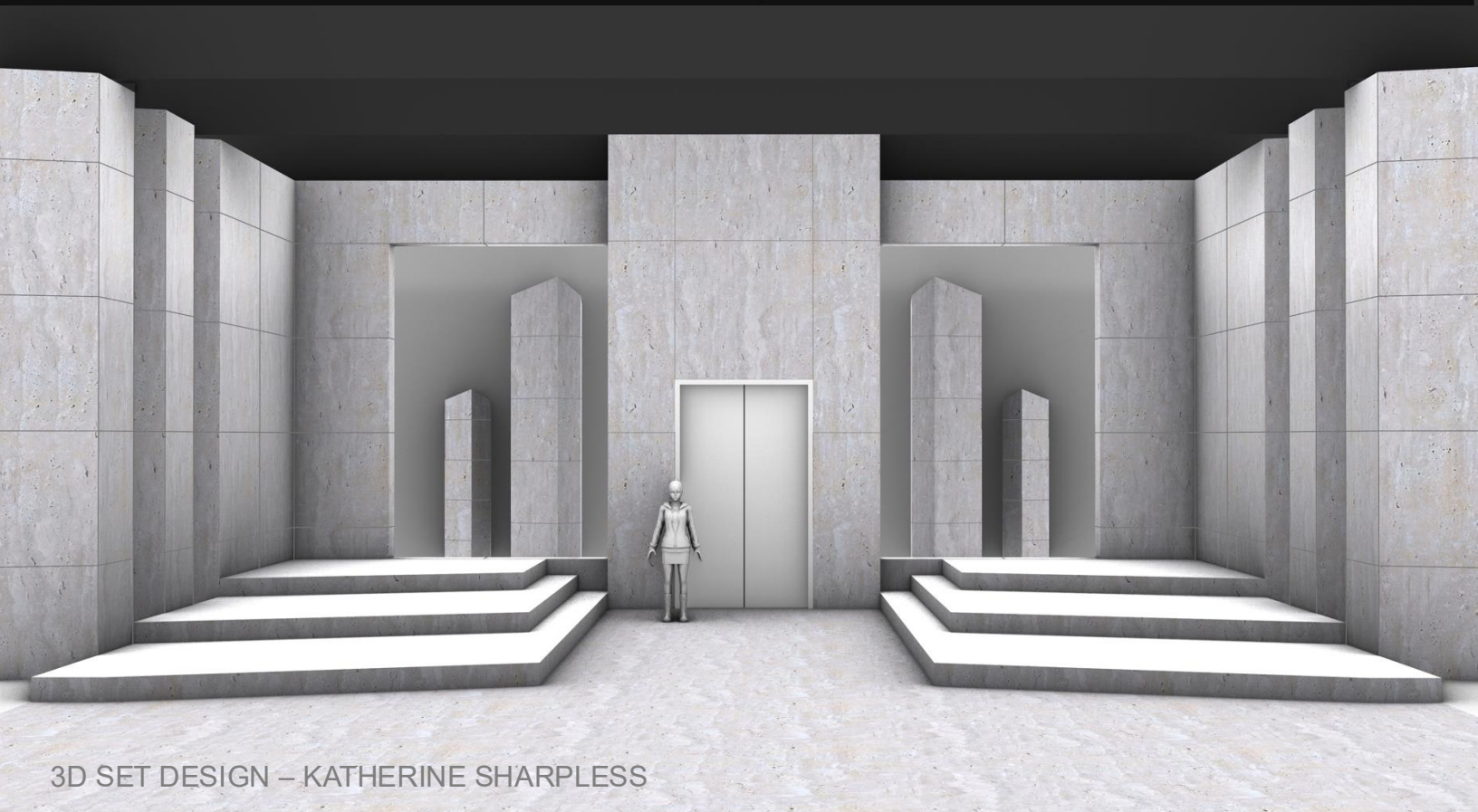
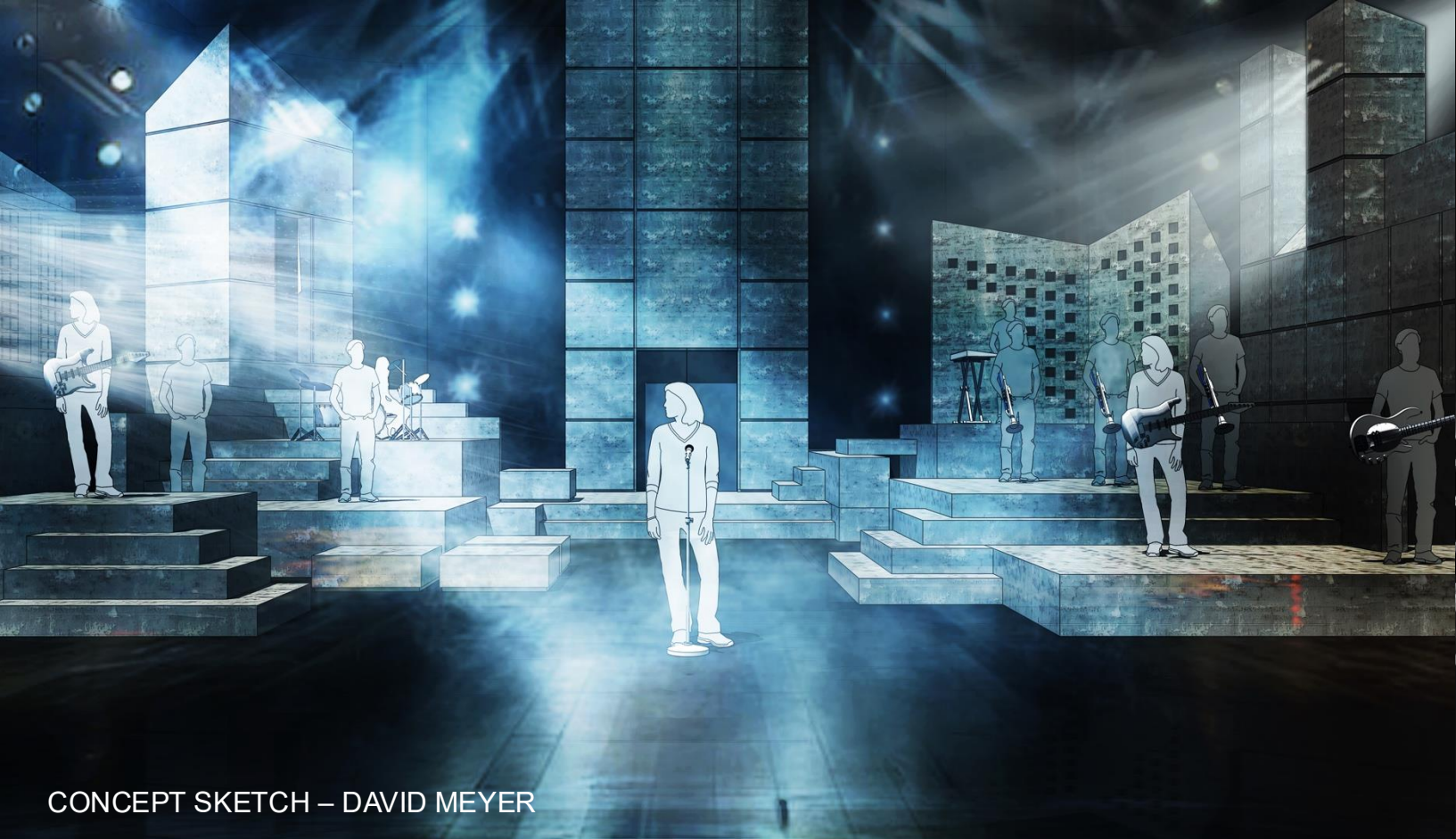

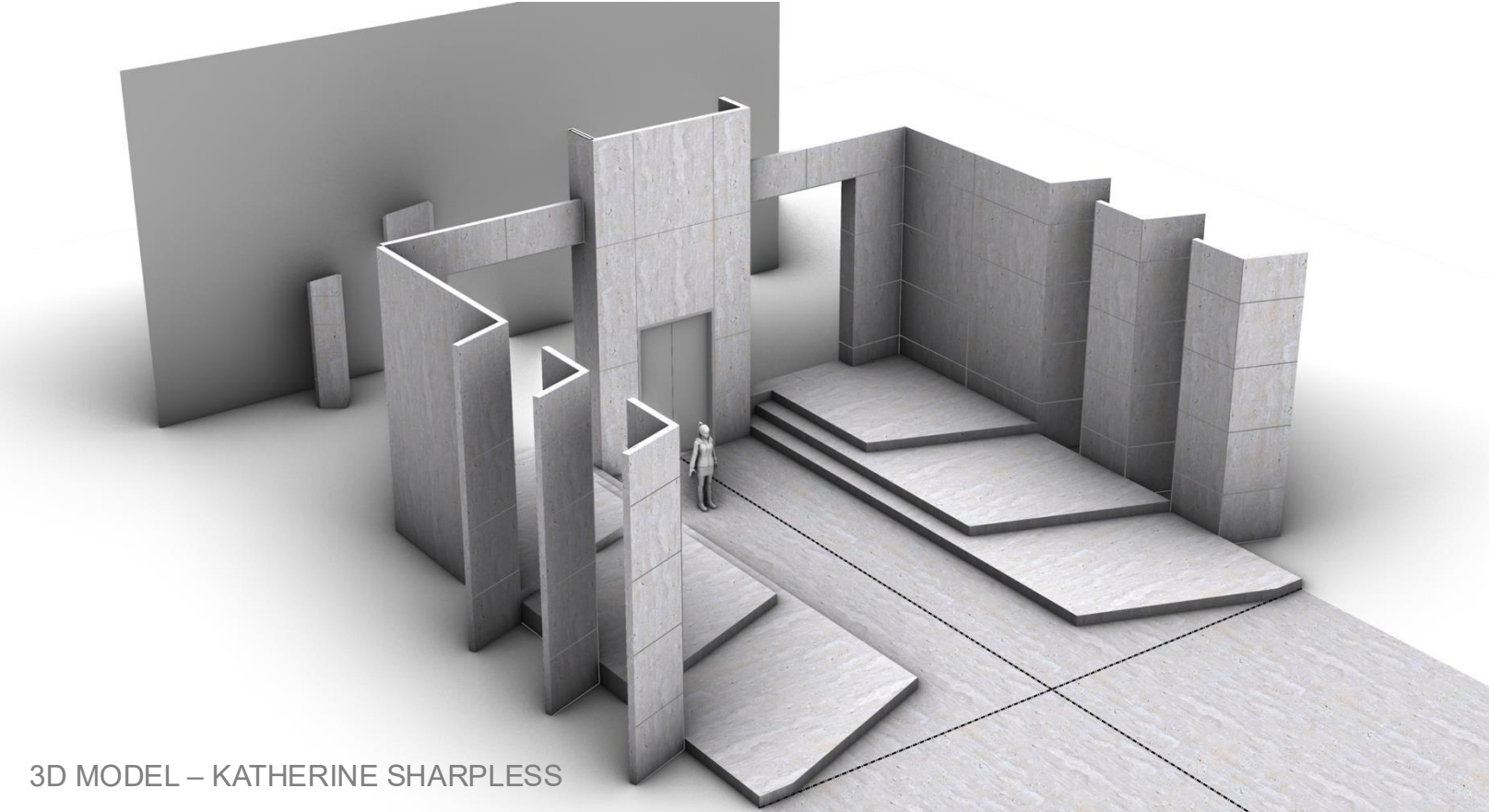

3D MODEL – KATHERINE SHARPLESS



SET BUILD – PRE LIGHT

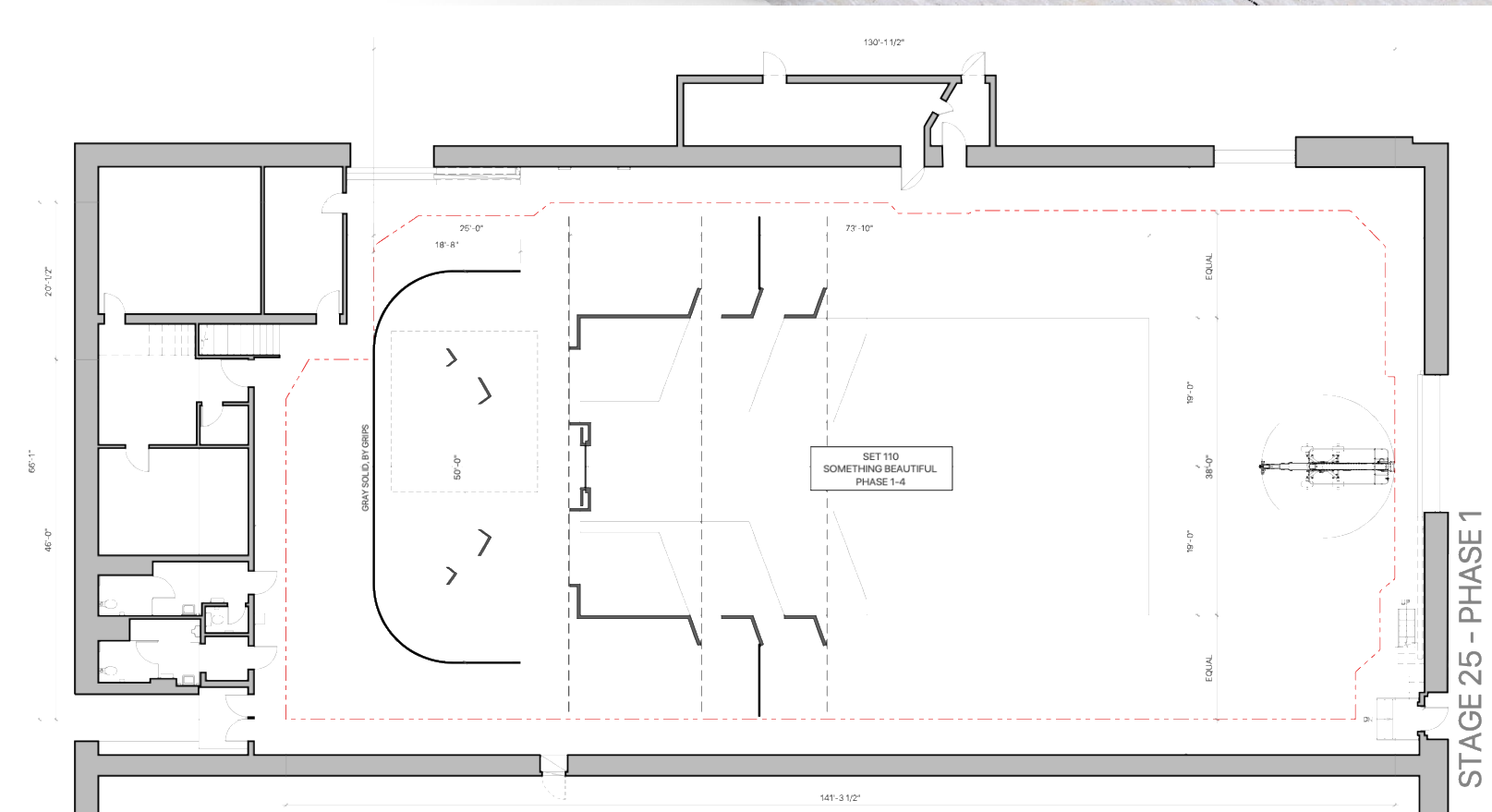

MILEY CYRUS | SOMETHING BEAUTIFUL



PHYSICAL MODEL – KATHERINE SHARPLESS & GRACE HINDLE





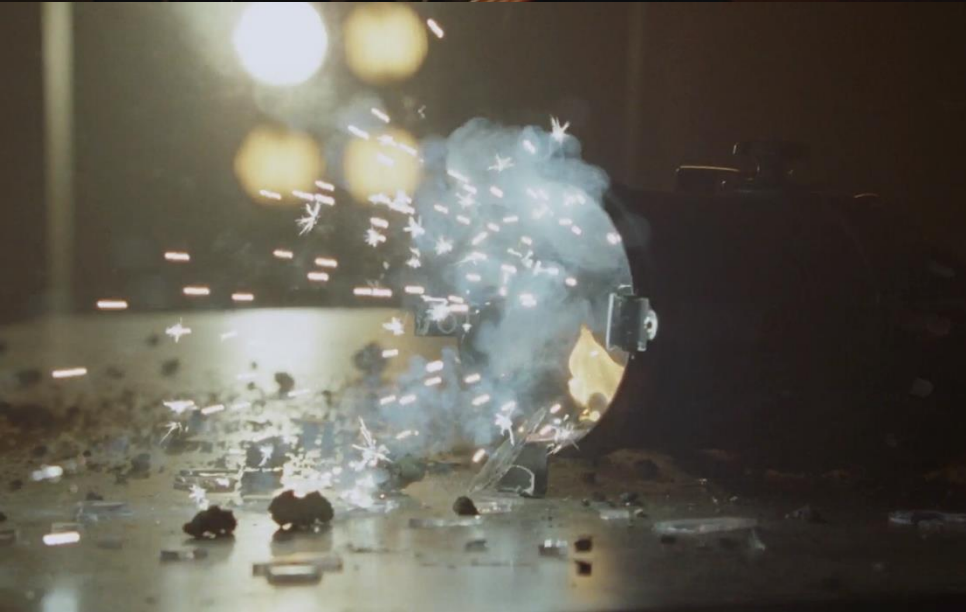

9

LIGHT SPARKS & FLASHES ABOVE SET

10

LIGHT DROPS FROM ABOVE SET

14

LIGHT HITS FLOOR, SPARKS & FLASHES, DUST FLIES

15

SPARKS FALL ON GUITAR

16

SPARKS FALL ON DRUM SET

18

SPARK & FLASH FROM A LIGHT ABOVE SET
LARGE PIECE OF CONCRETE DEBRIS FALLS FROM ABOVE SET

19

EXTRA SMASHED & BURNED OUT LIGHTS DRESSED TO CAMERA

22

ANOTHER LIGHT SPARKS & FLASHES ABOVE SET

23

CHUNK OF ELEVATOR WALL FALLS & DUST FLIES

23

CHUNK OF ELEVATOR WALL HITS FLOOR & DUST FLIES

24

LIGHTING WIRE SPARKS ABOVE SET

25

PYRO FLASHES, SPARKS SHOWER DOWN, SMOKE & DEBRIS FROM WING WALLS

34

ELEVATOR SHAFT WALL BLOWS OPEN
SMOKE, DUST, & DEBRIS FLIES

38

SPARKS SHOWER DOWN

39

DUST & SMOKE SHOOT FROM BELOW AS PROJECTED IMAGE IS SHOT ON A CONCRETE WALL

42

THREE LIGHTS FALL FROM ABOVE SET

44

SPARKS SHOWER DOWN

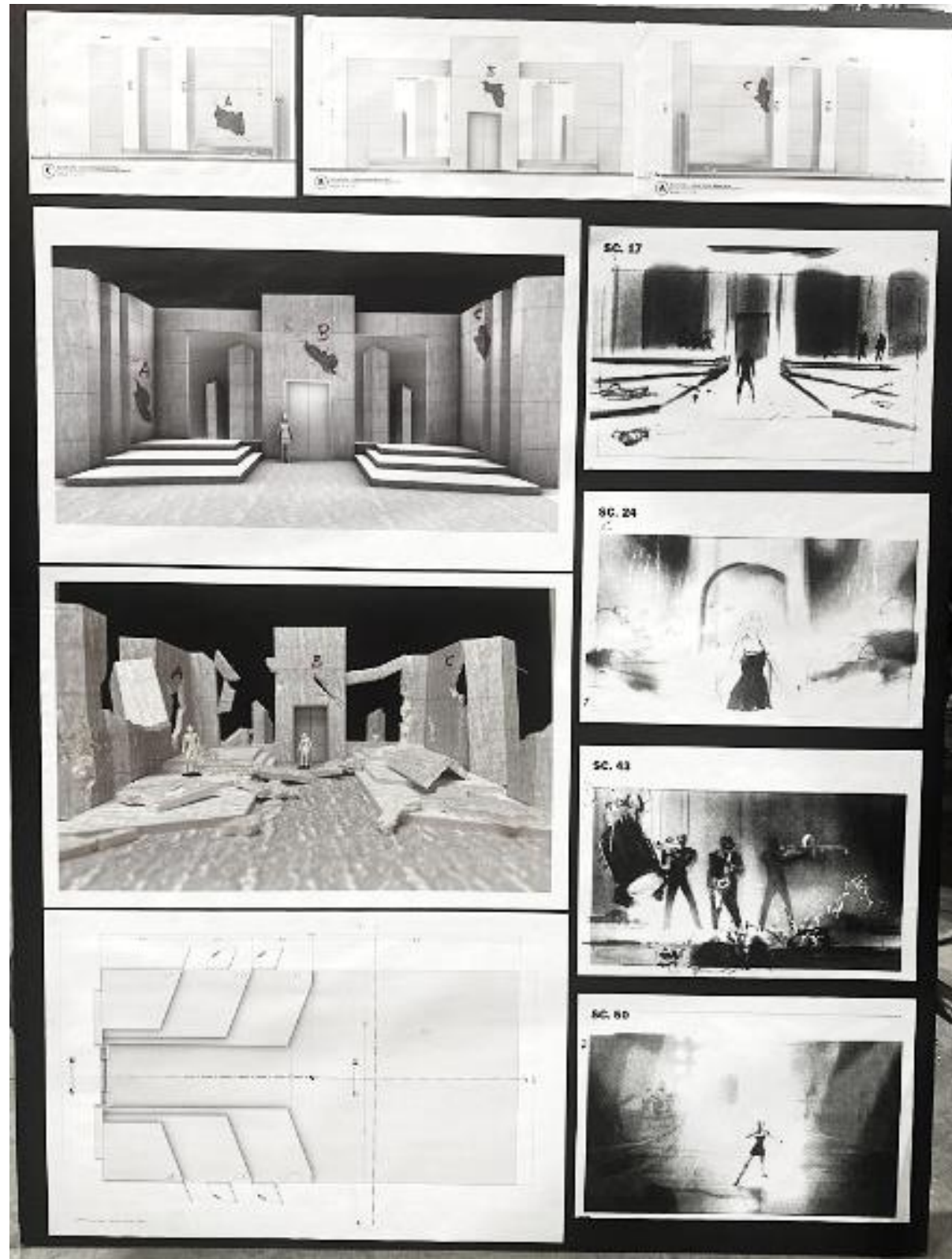
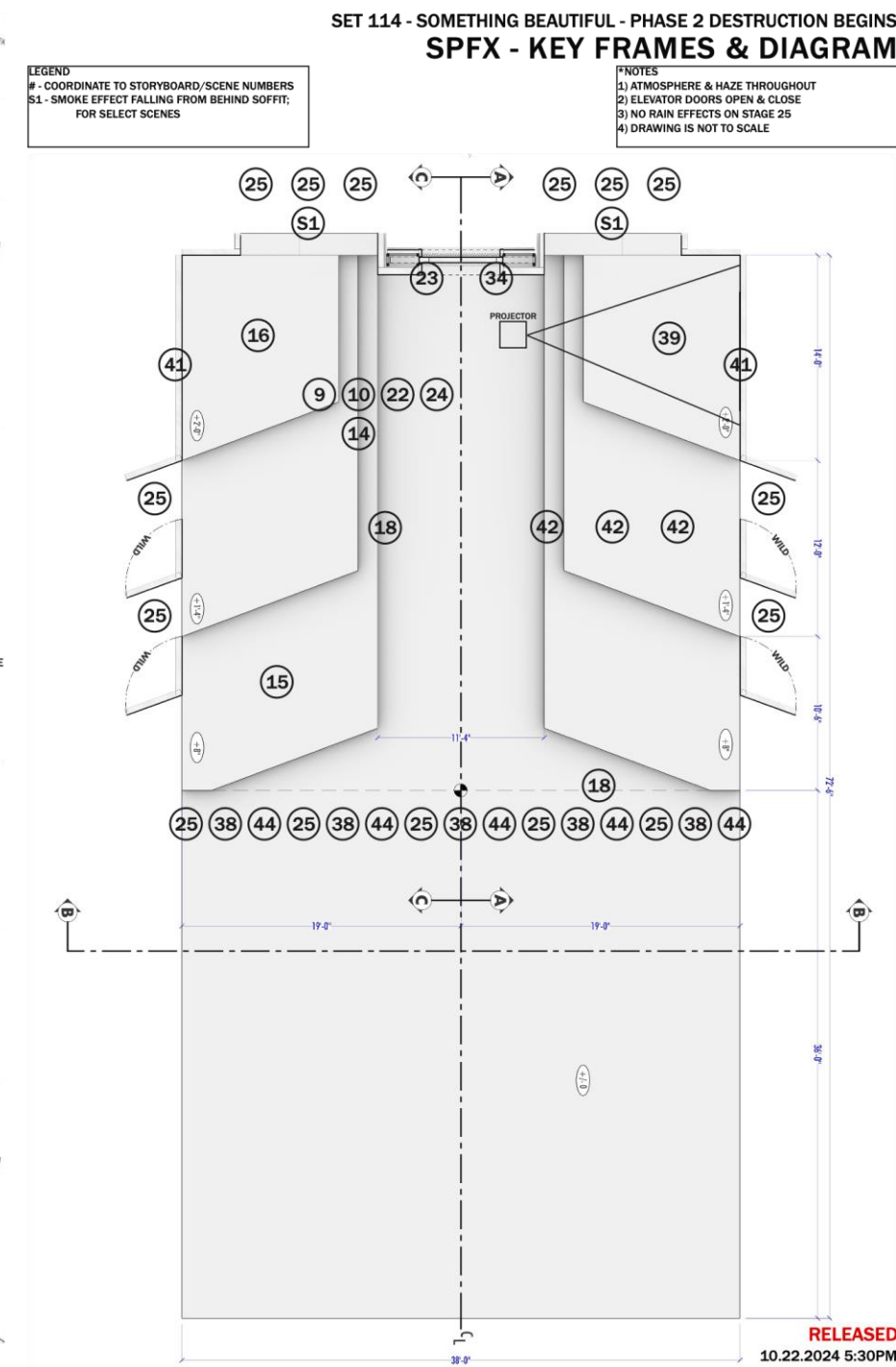





1 DAY
CHANGE-
OVER
TO
DESTROYED
SET



17



STOREY BOARD – SAM HUDECKI



PHYSICAL MODEL – KATHERINE SHARPLESS & GRACE HINDLE



PHYSICAL MODEL – KATHERINE SHARPLESS & GRACE HINDLE



DESTRUCTION CHANGE - OVER









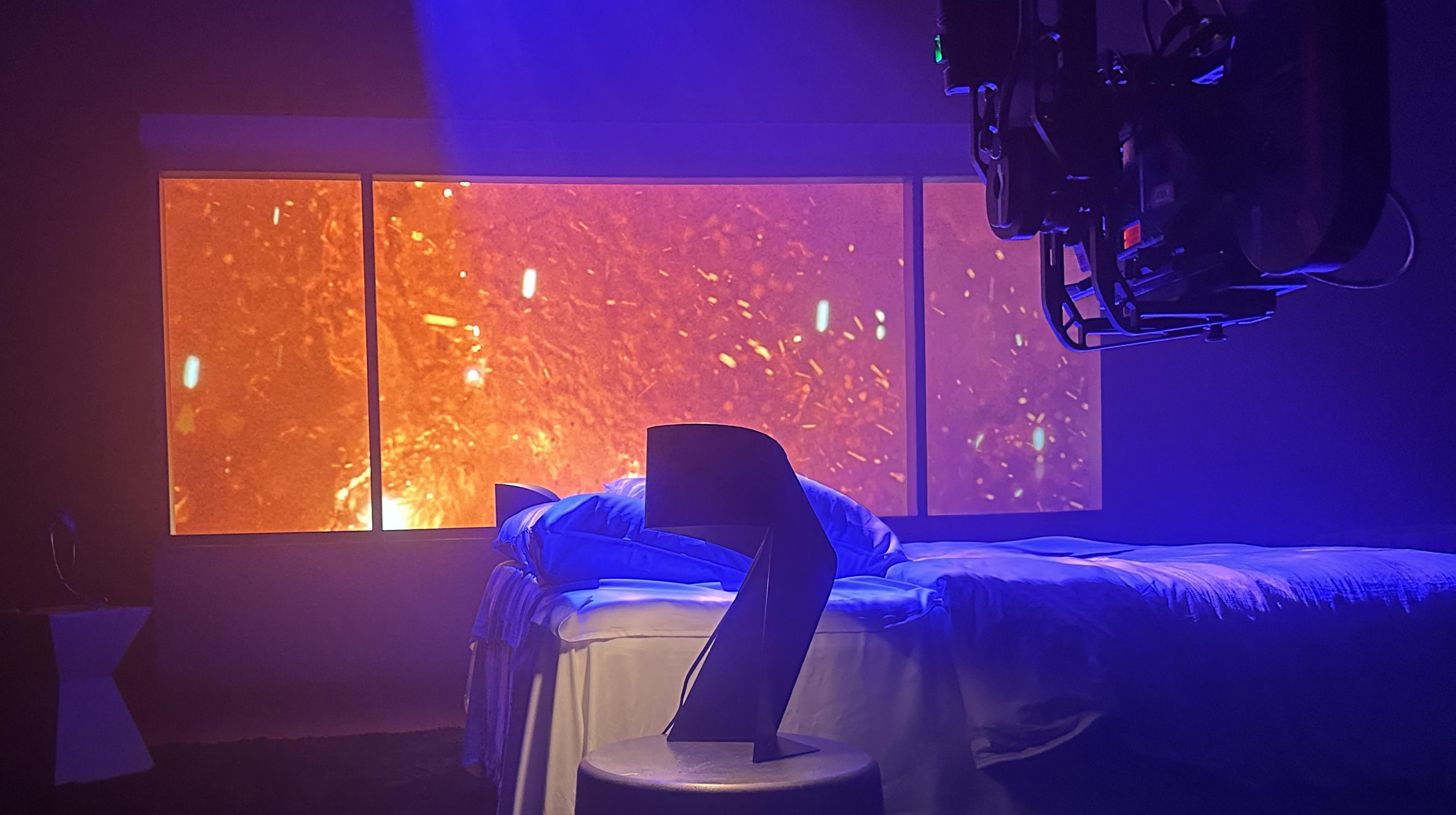



3D CONCEPT RENDERING

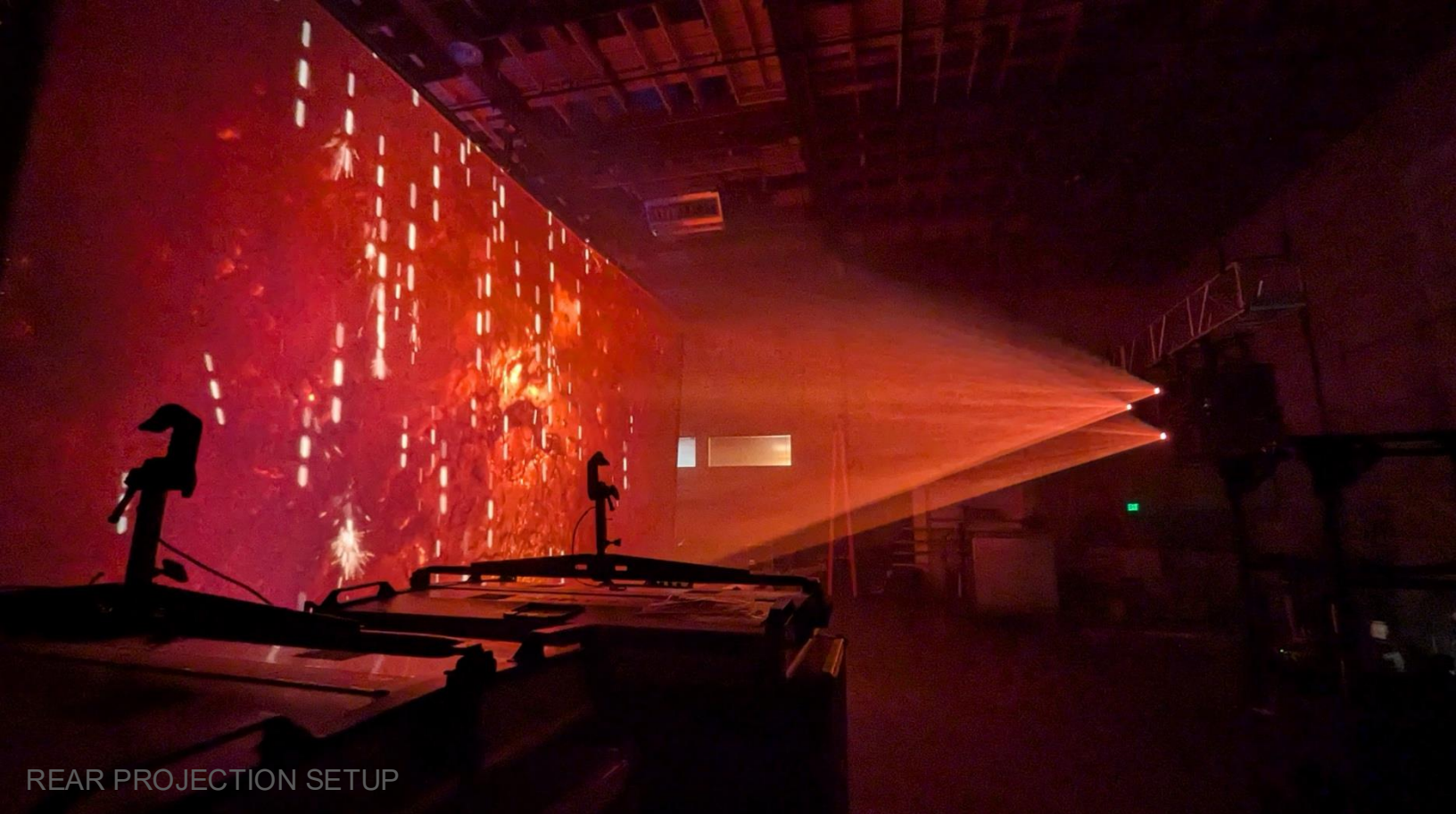

REAR PROJECTION SETUP

“END OF THE WORLD”

SET 121 - BED SET

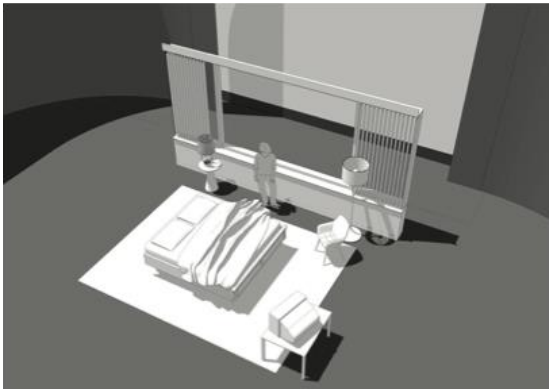

MODEL VIEW



STORYBOARD

- CONST.:**
- WINDOW FLAT
- PAINT:**
- WINDOW FLAT
- SET DEC.:**
- KING SIZED BED
 - PILLOWS, SHEETS, ETC
 - HORIZONTAL BLINDS
 - SIDE TABLE & CHAIR
 - RUG
- RIGGING:**
- BLACKOUT CURTAIN ON TRACK TO FRAME CENTER PORTION OF REAR-LIT PROJECTOR SCREEN
- SPFX:**
- ATMOSPHERE

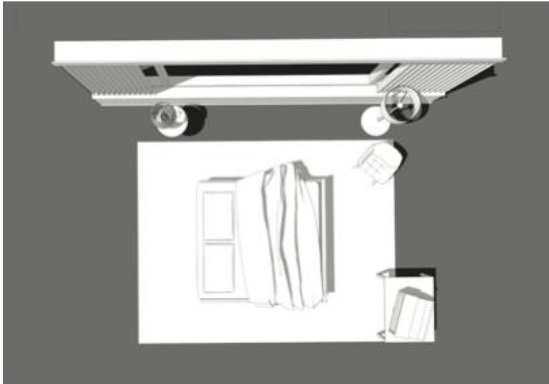

MODEL VIEW - TOP VIEW



MODEL VIEW





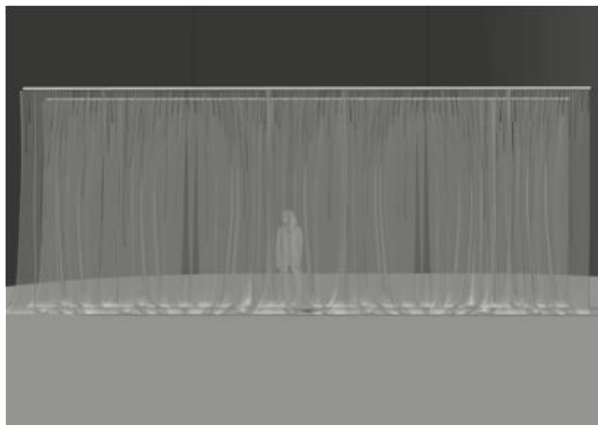

MODEL VIEW

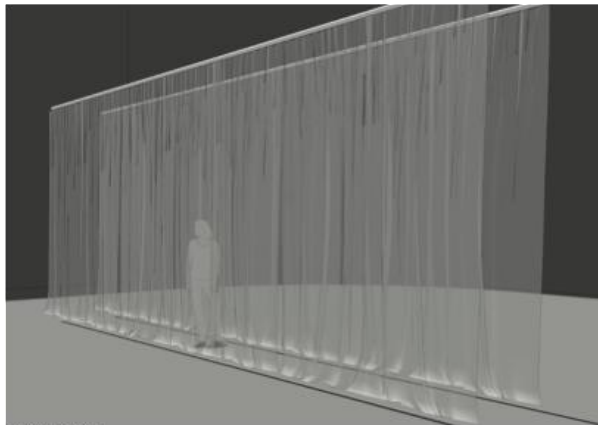

MODEL VIEW

- SET DEC:**
- SHEETS FOR TUNNEL; ALLOW OPENINGS FOR CAMERA & SPFX
 - OVERSIZED SHEETS FOR BILLOWING/DRAPING AROUND M.C.
- RIGGING:**
- REUSE BLACKOUT CURTAIN AND LIGHT RIG FROM EASY LOVER?
 - AS REQ'D FOR OVERSIZED SHEETS
- SPFX:**
- ATMOSPHERE
 - WIND / AIR MOVEMENT AS REQ'D
 - WIRE AS REQ'D TO ANIMATE SHEETS

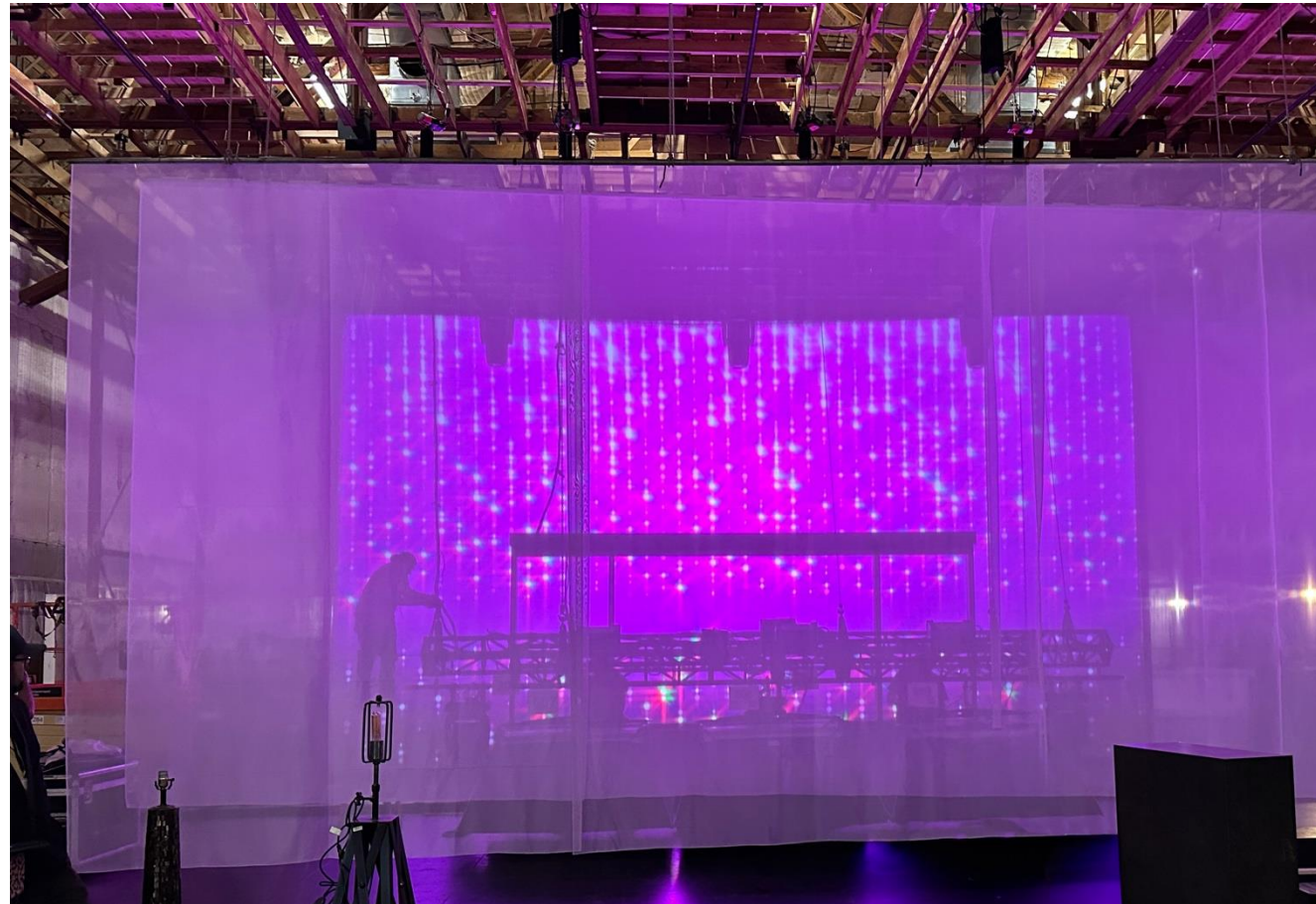







MODEL VIEW



MODEL VIEW

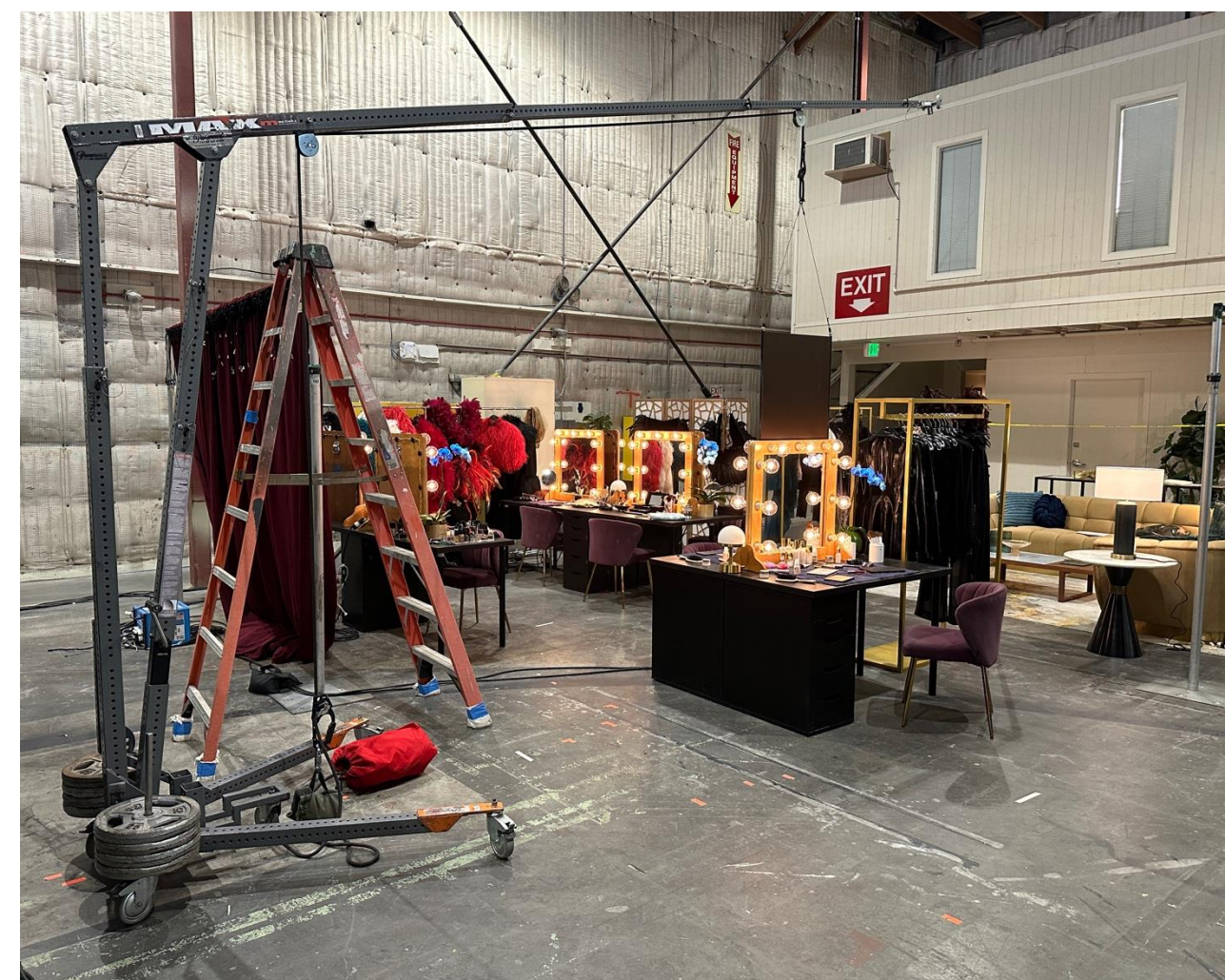
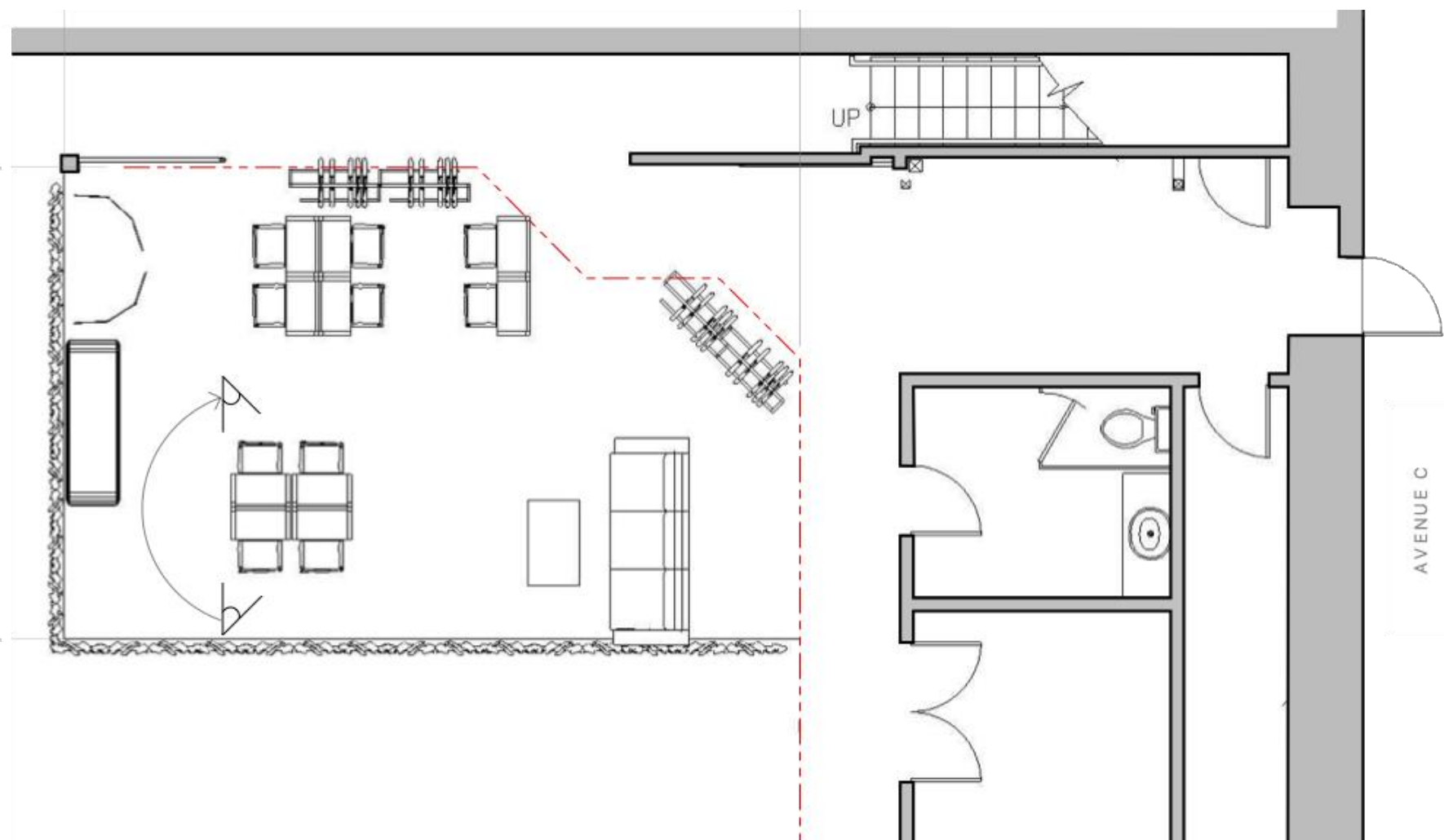

MIRROR TRICK
SLIDES IN
FROM ABOVE

CONTINUOUS
SHOT WITH
PHOTO
DOUBLE AND
DOUBLED SET
DRESSING











ON SET PHOTO



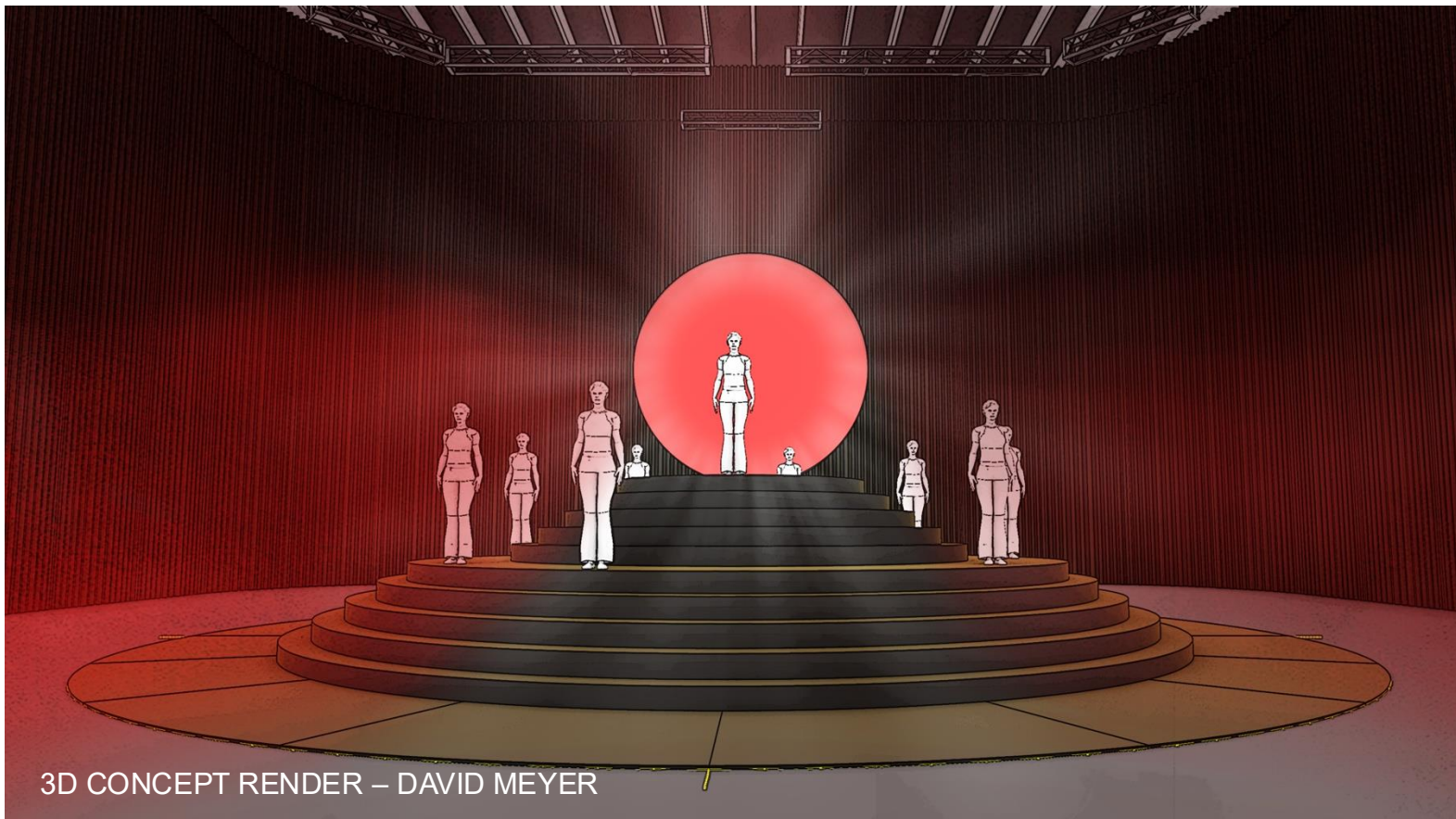
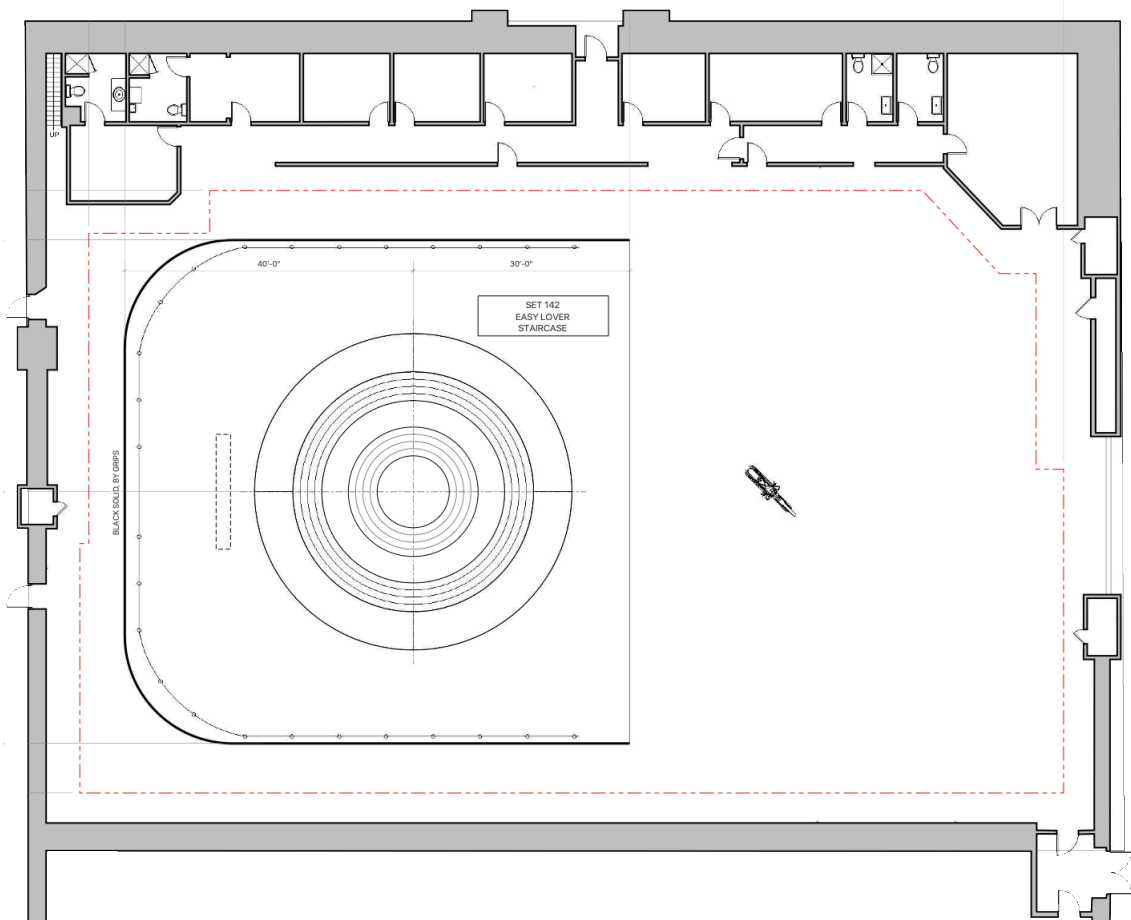
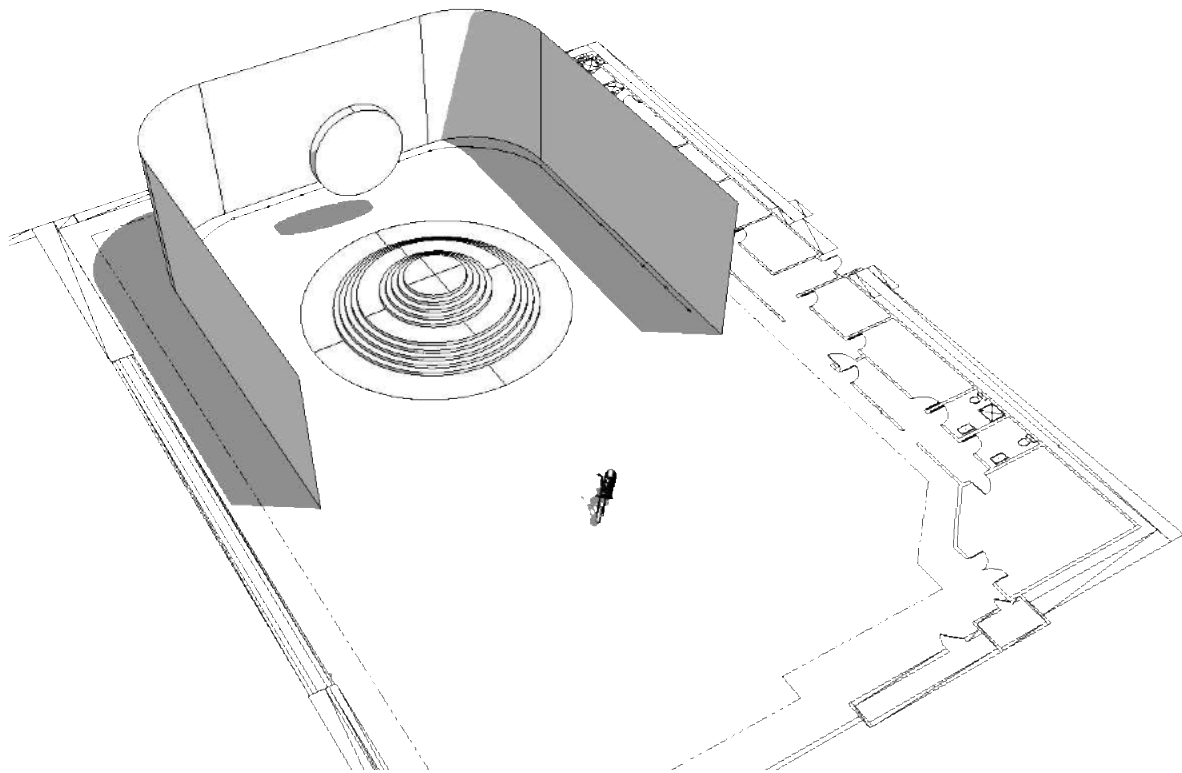

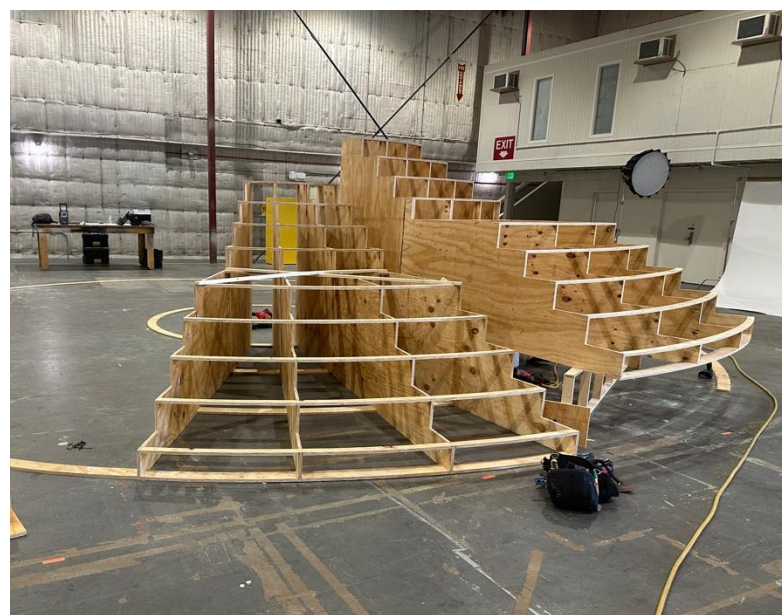
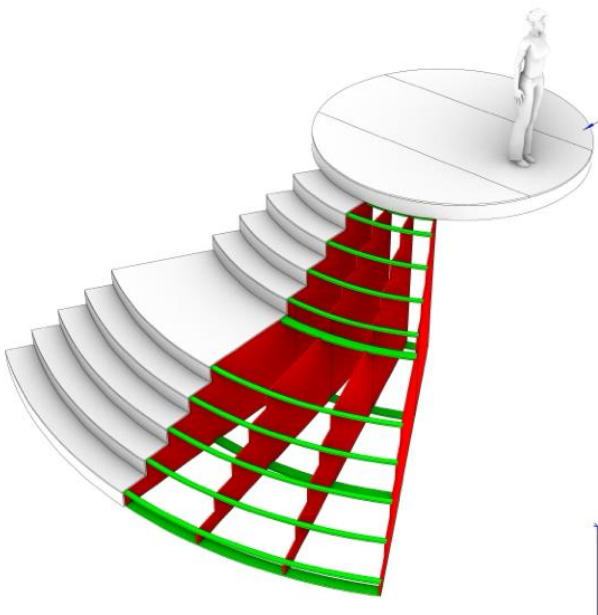

BUILD - STAGE 24

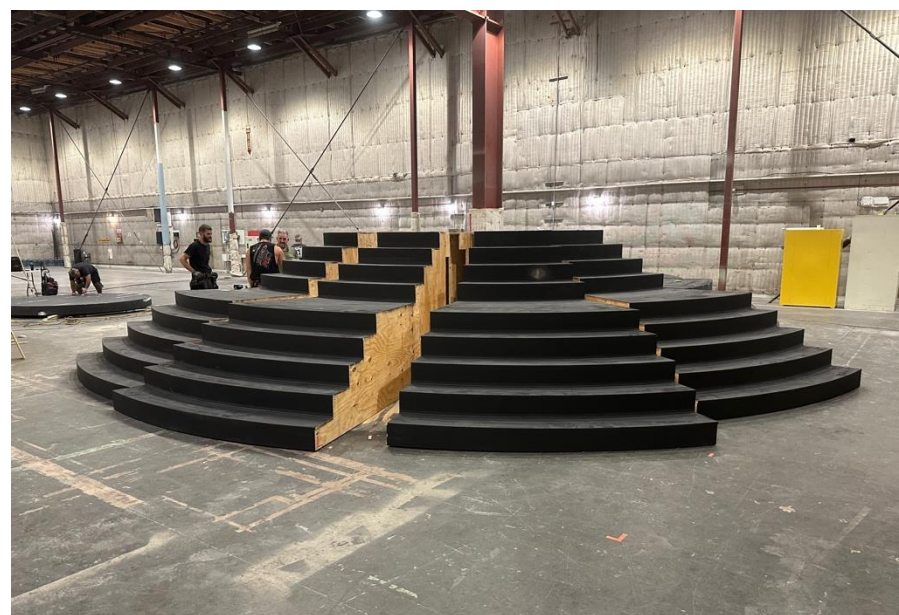

BREAKDOWN & MOVE TO STAGE 32



REHEARSAL - STAGE 24



LIGHTING TEST - STAGE 32

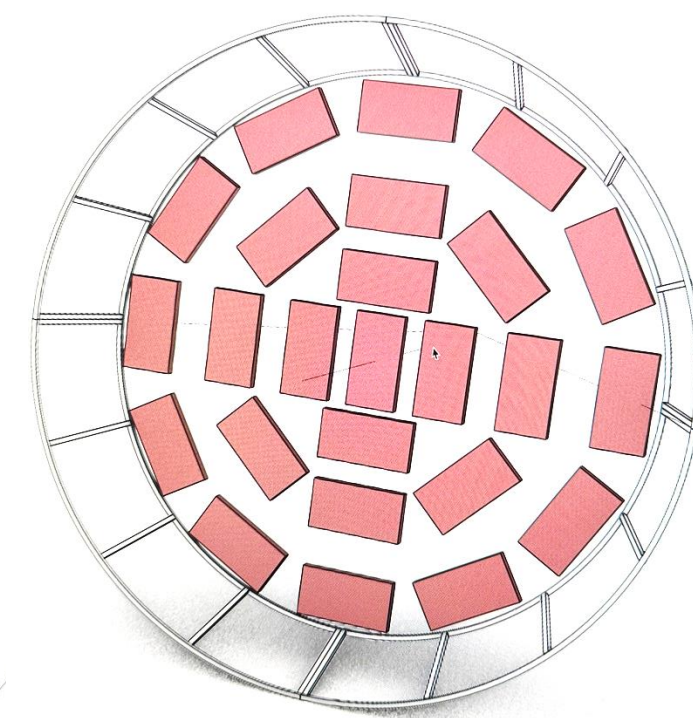
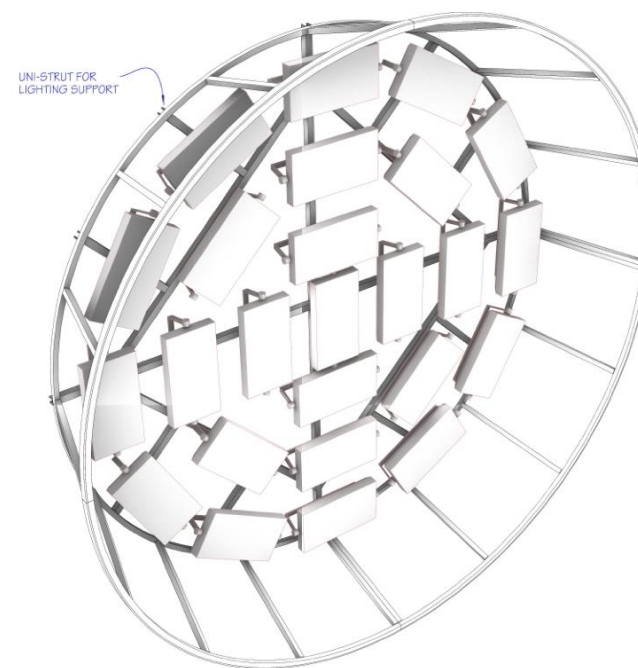
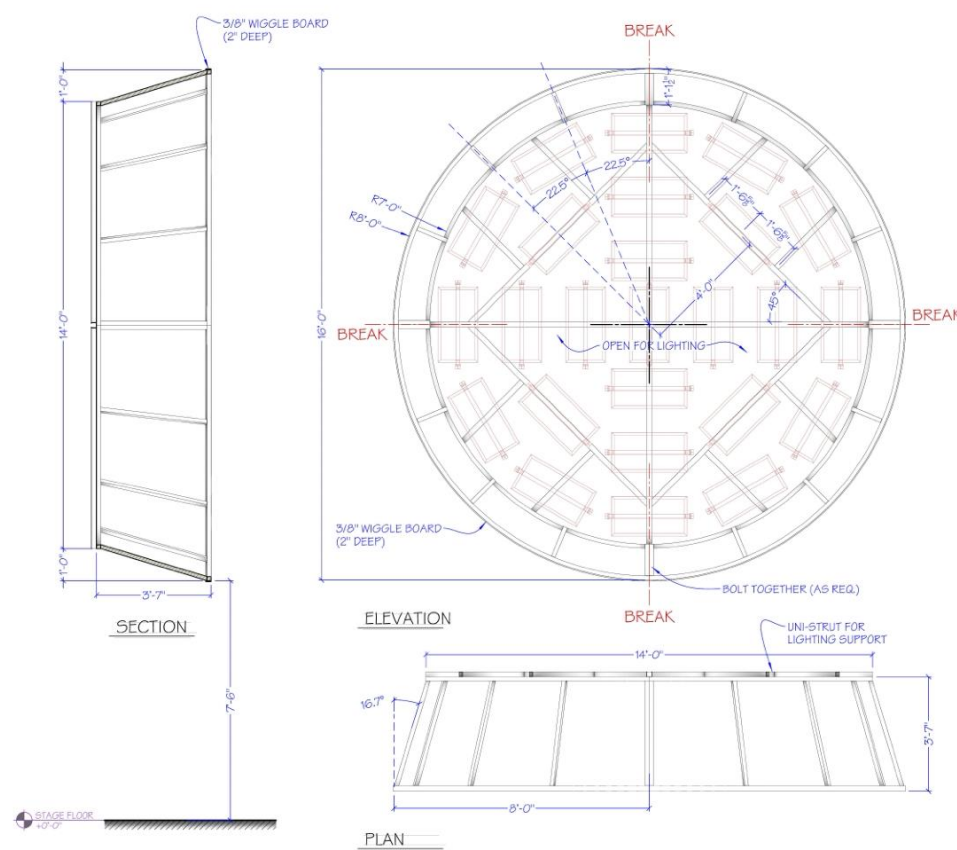

A SUN FRAME LAYOUT - OPTION "A"
SCALE: NONE

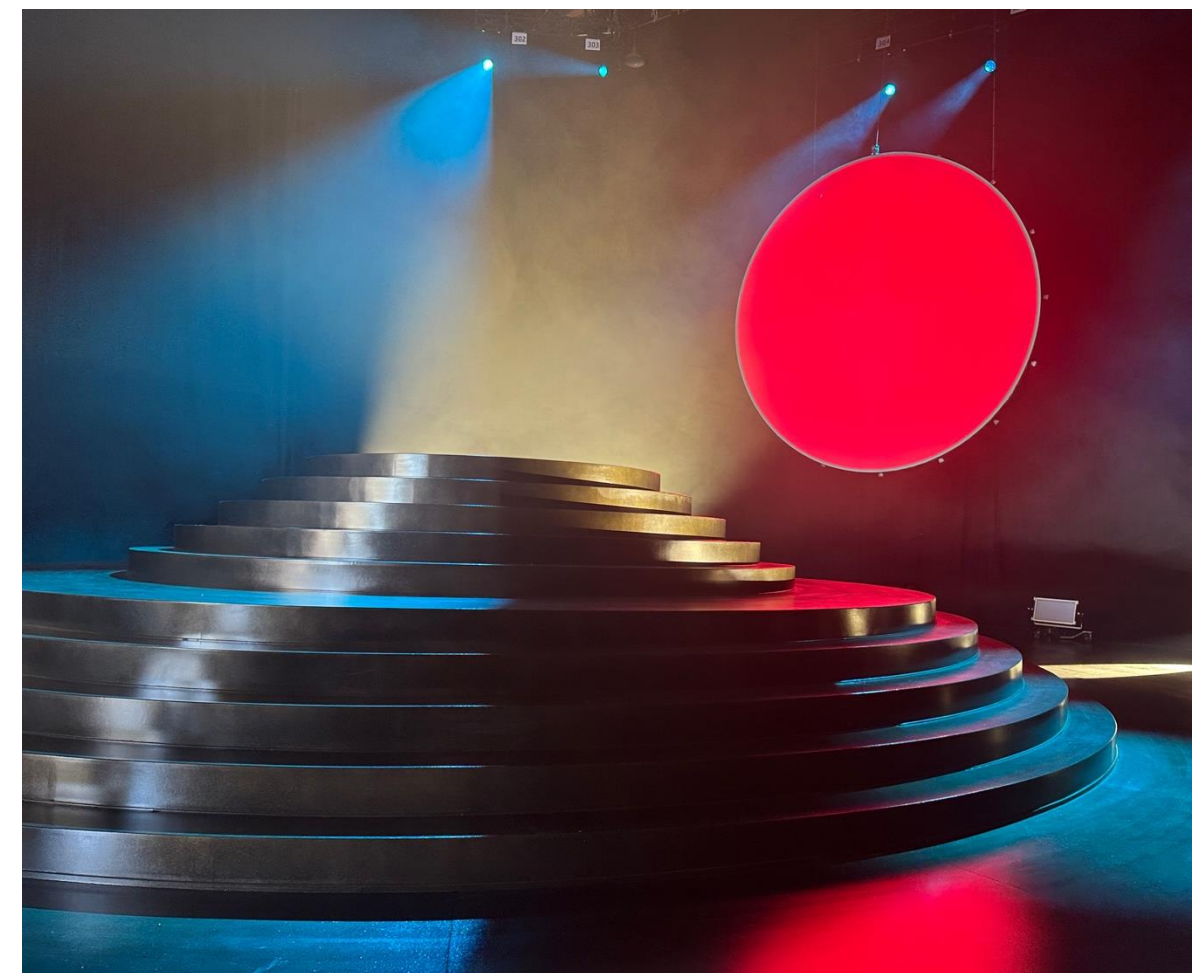
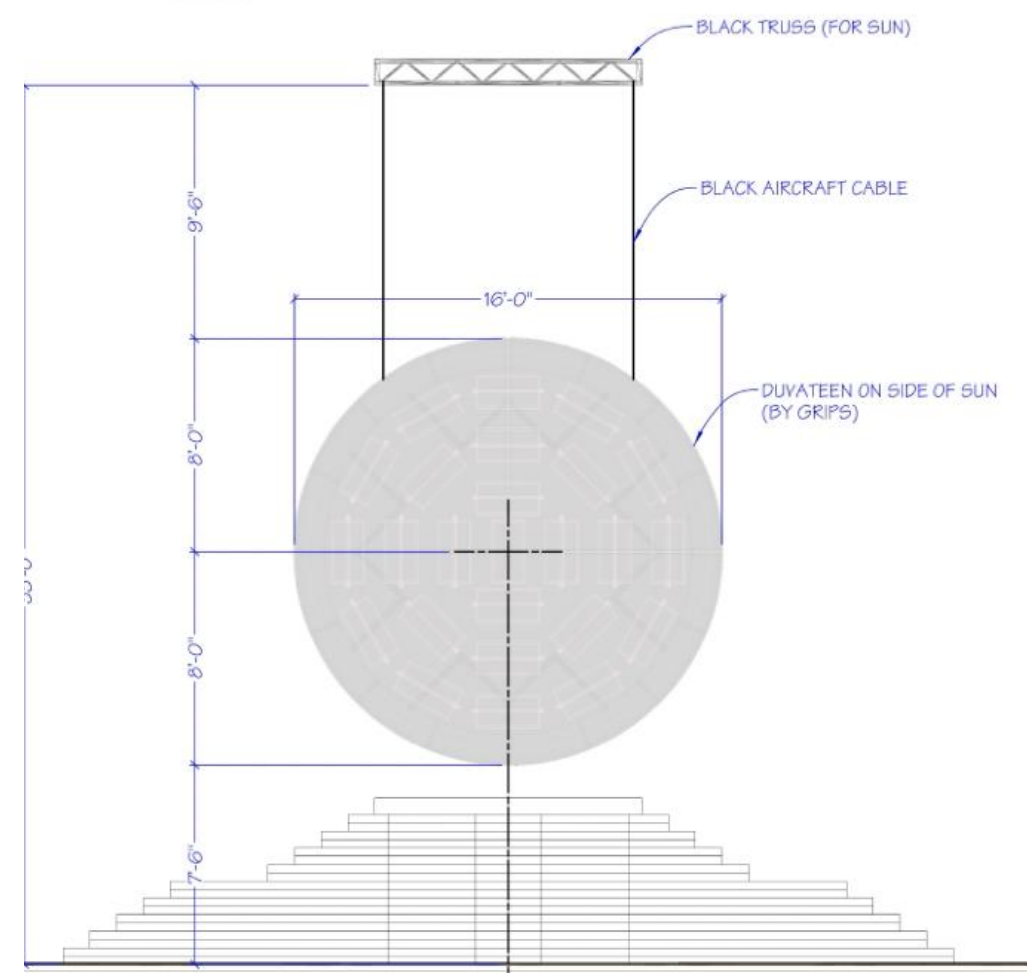



REHEARSAL - STAGE 32

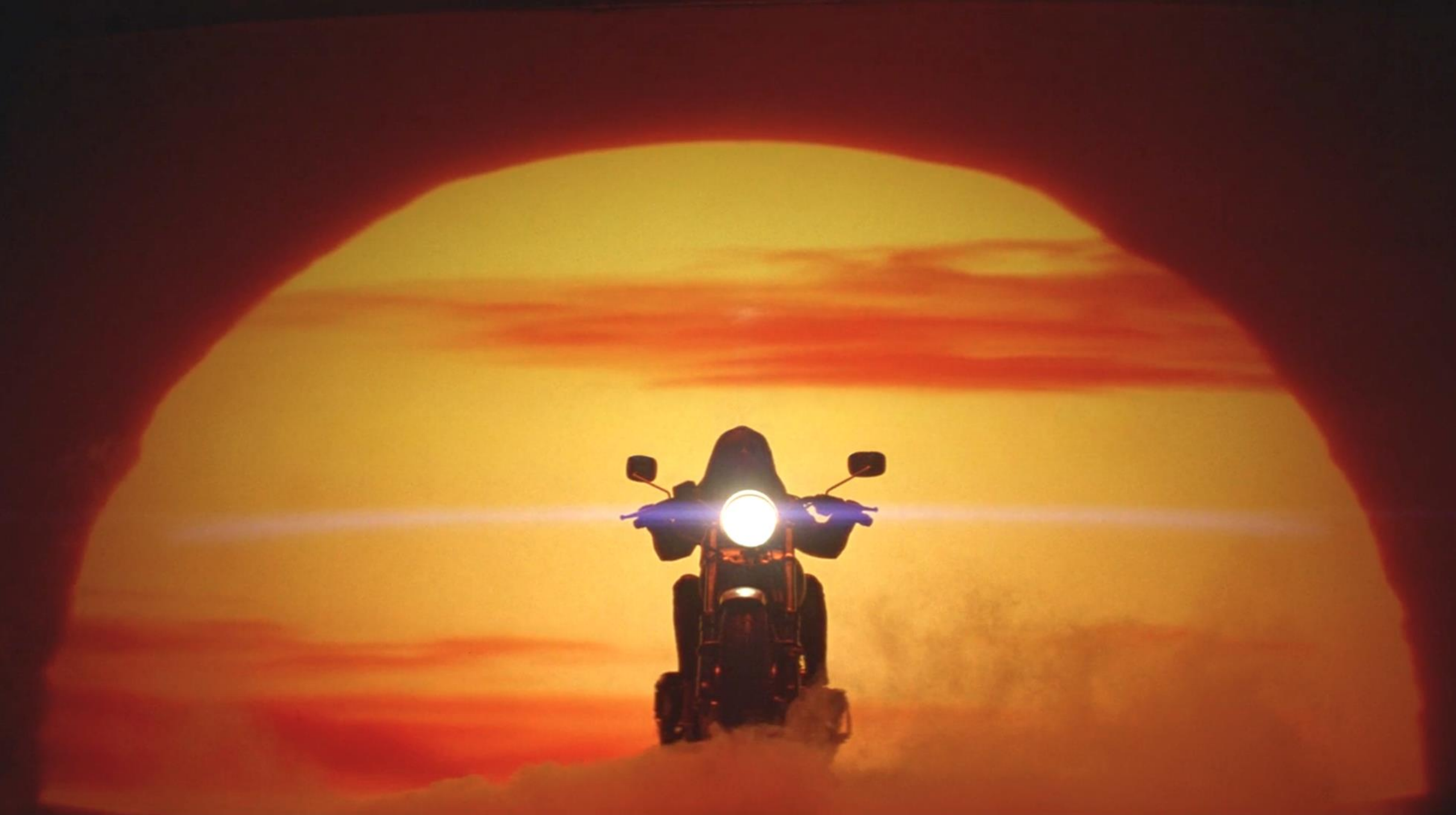



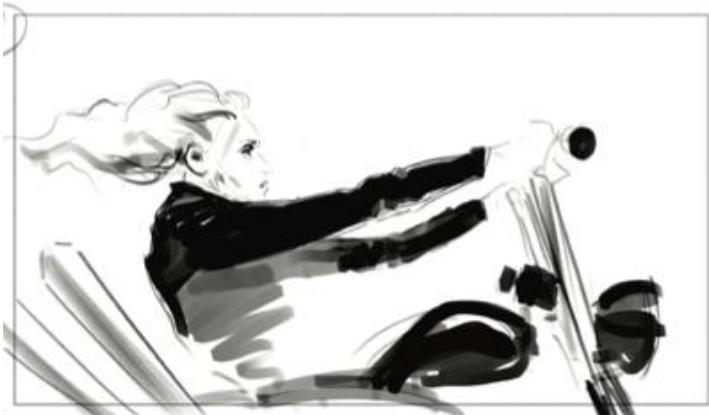









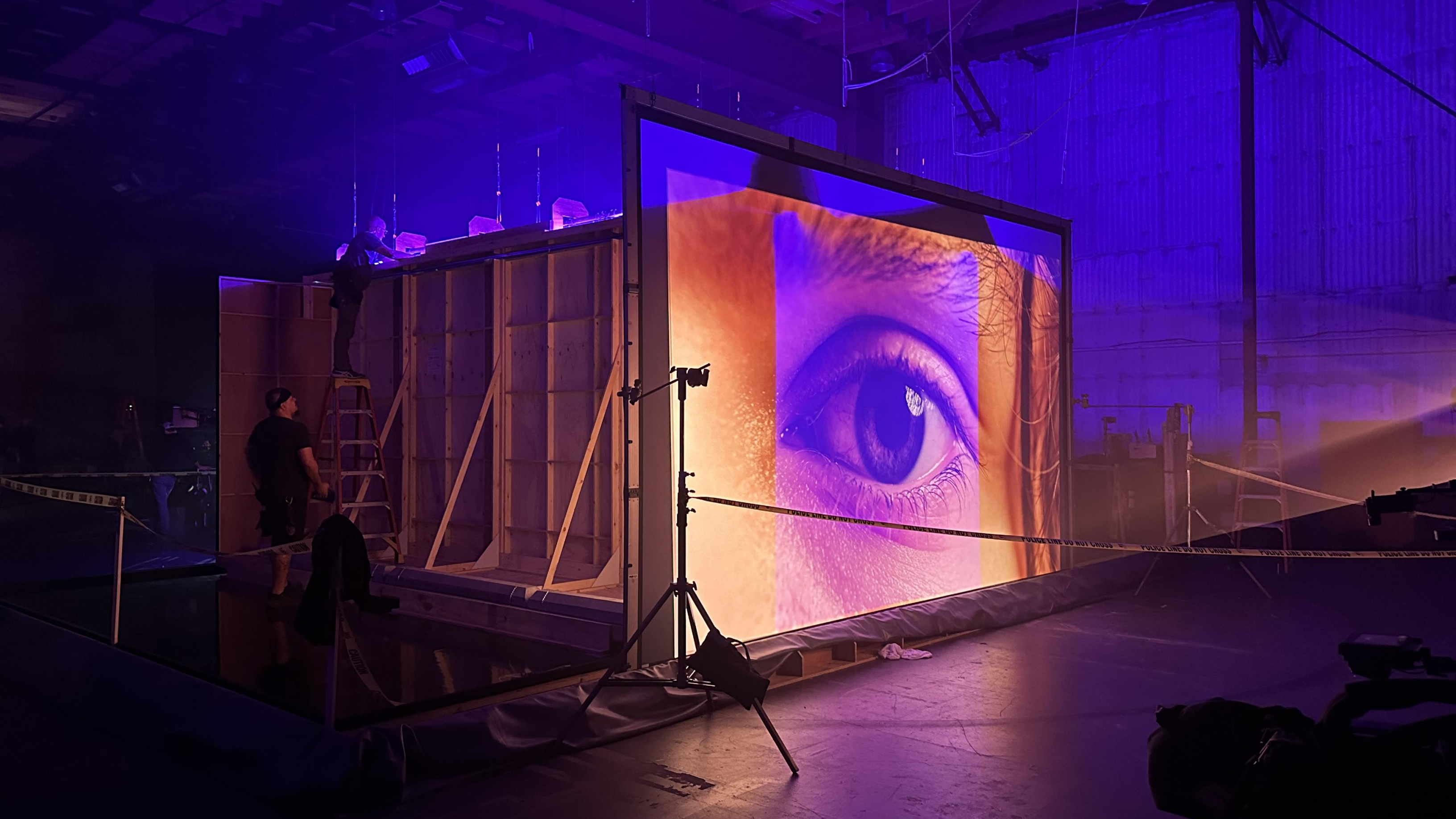

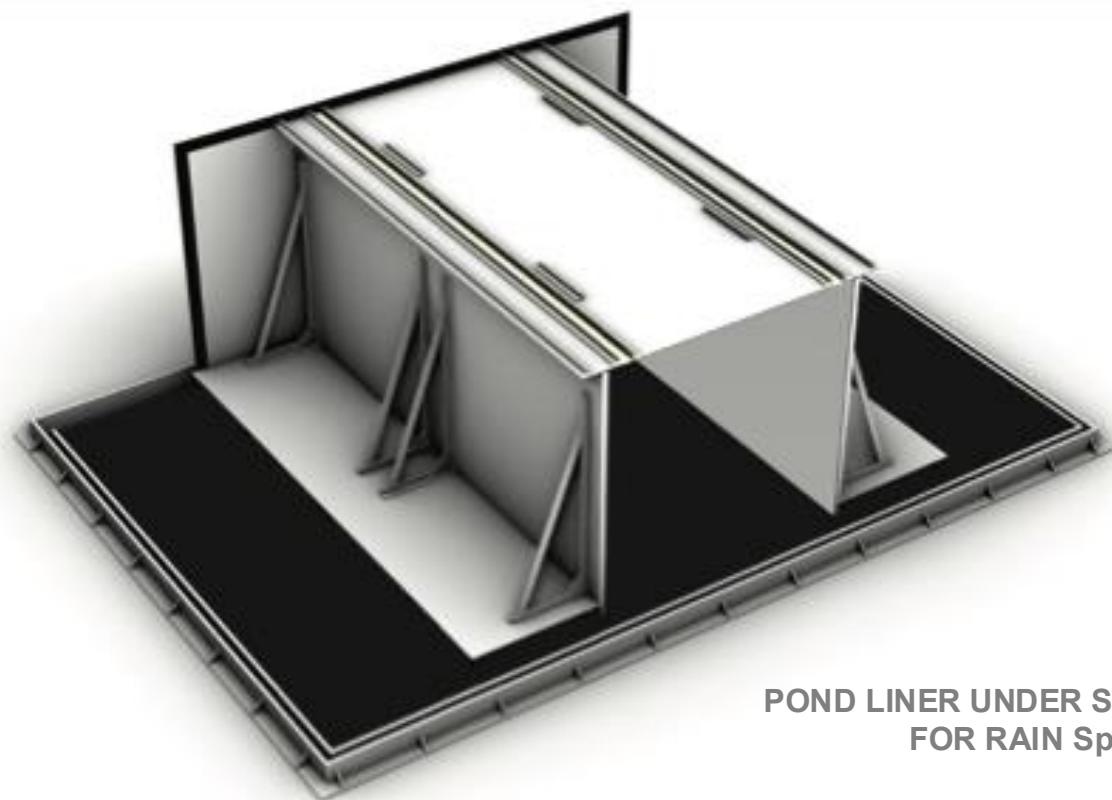
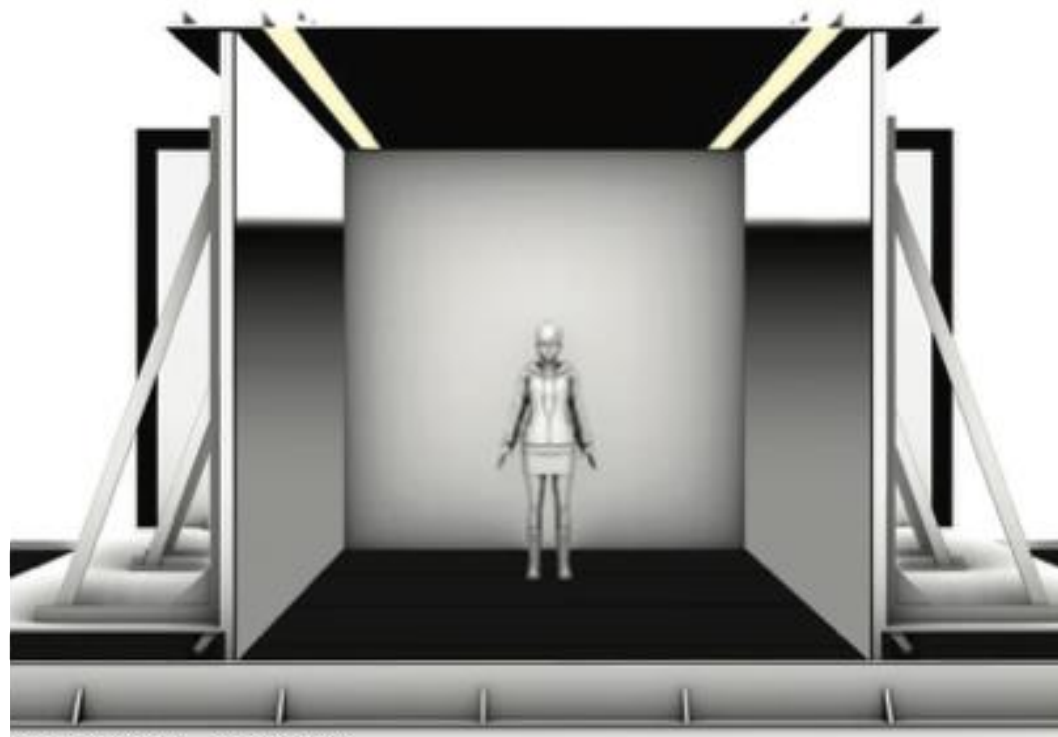
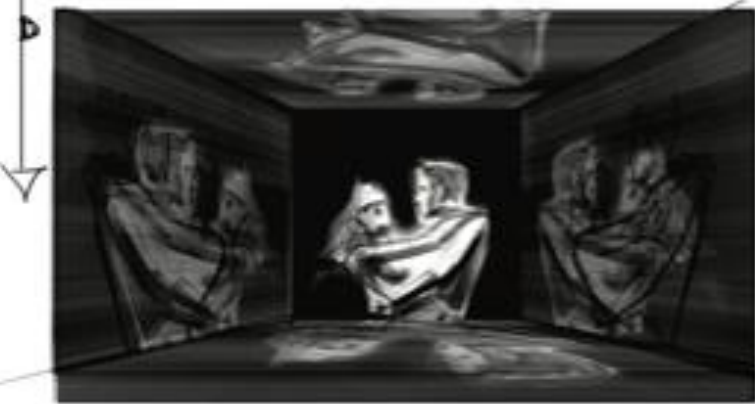

MODEL VIEW

POND LINER UNDER SET
FOR RAIN SpFX







PRELUDE



SOMETHING BEAUTIFUL



REBORN

